

**+NOTICE!!**

**These documents have been scanned!**

**Do not place un-scanned documents beneath this notice!**

**Do not remove this notice from this file!**

GPO Jacket No. 560-102  
Print Order 61540  
Rise Business Services, LLC  
Job=AZ15 7/15/2019



Box Number= AZ15164



Claim Begin-End: AMC336027-AMC336034

**1 Initial Receipt**



AZ15164-10

AMC335259-AMC337099

# CLAIM INDEX

DATE PREPARED: December 15, 1998

LEAD OWNER: Tomas Mills  
5338 SW Urish  
Topeka, Kansas 66610

LEAD AMC NUMBER: AMC 336027  
THRU  
ENDING AMC NUMBER: AMC 336034

<u>AMC NUMBER</u>	<u>*CLOSURE DECISION</u>	<u>CLAIM NAME</u>	<u>LOCATORS OF RECORD</u>
336027		SMH #1	Thomas Mills
336028		SMH #2	Thomas Mills
336029		SMH #3	Thomas Mills
336030		SMH #4	Thomas Mills
336031		SMH #5	Thomas Mills
336032		SMH #6	Thomas Mills
<del>336033</del>	12-14-95	<del>SMH #7</del>	Thomas Mills
<del>336034</del>	12-14-95	<del>SMH #8</del>	Thomas Mills

FOR BLM PURPOSE ONLY

UNITED STATES  
DEPARTMENT OF THE INTERIOR  
BUREAU OF LAND MANAGEMENT

RECEIPT AND ACCOUNTING ADVICE

NO. **2189979** 04

TC/AZ 11/21/95

Subject: LOCATION & SERVICE FEE (8) 2 36 11 200.00  
 Applicant: CLAIM MAINTENANCE FEE 1996 (8) 2 36 12 80.00  
 TOM MILLS 2 36 13 800.00  
 5338 SW URISH  
 TOPEKA, KS 66610

Remitter: VICTORIA J. BLACKBURN  
 51033 N. 330TH AVE.  
 P.O. BOX 20238  
 WICKENBURG, AZ 85358

Assignor: 913-478-0155

LEASE MANAGEMENT DATA									
<input type="checkbox"/> NEW <input type="checkbox"/> UPDATE <input type="checkbox"/> PAYMENT									
ORIGINAL SERIAL NO.	ASG.	TYPE	ST.	CTY.	FUND SYMBOL			ACRES/UNITS	RATE
AMC 336027, ET AL									
AMOUNT	ANV. DATE	EXP. DATE	BILL CYC.	S/C	DISTRICT	NEXT BILL	MISC. DATA	U of M	ACTUAL UNITS
ASSIGNMENT SERIAL NO.	ASG.	TYPE	ST.	CTY.	FUND SYMBOL			ACRES/UNITS	RATE
AMOUNT	ANV. DATE	EXP. DATE	BILL CYC.	S/C	DISTRICT	NEXT BILL	MISC. DATA	U of M	ACTUAL UNITS

APPLY REMITTANCE			
ACTION	FUND SYMBOL	CTY.	AMOUNT
FILING FEE			
RENTAL			
UNEARNED			
REFUND			\$250.00
TOTAL			
AMOUNT DUE			

Remarks:  
 2/5/96  
 No Federal Minerals in 5 1/2 Sec. 28, T. 12N R. 9W.  
 Mining claims SMH #7 (AMC 336033) and (SMH #8) null & void.  
 (AMC 336034)

BY: *[Signature]* DATE: 2/5/96

Lease in Escrow?  
 KGS?  
 Auto Escalates?  
 Auto Renew?

Of Interest?  
 Operating Rights?  
 Operator  
 Bond Filed?

**FOR MMS USE ONLY**

BILLEE NUMBER	FOREST REFUGE
OCS SECTION	
CODE	

**NOTICE!!**

**These documents have been scanned!**

**Do not place un-scanned documents beneath this notice!**

**Do not remove this notice from this file!**

GPO Jacket No. 560-102  
Print Order 61540  
Rise Business Services, LLC  
Job=AZ15 7/15/2019



Box Number= AZ15164



Claim Begin-End: AMC336027-AMC336034

**2 Correspondence**



AZ15164-10

AMC335259-AMC337099

**NO  
DOCUMENTS  
FOUND**

NO DOCUMENTS FOUND  
NO DOCUMENTS FOUND

**NOTICE!!**

**These documents have been scanned!**

**Do not place un-scanned documents beneath this notice!**

**Do not remove this notice from this file!**

GPO Jacket No. 560-102  
Print Order 61540  
Rise Business Services, LLC  
Job=AZ15 7/15/2019



Box Number= AZ15164



Claim Begin-End: AMC336027-AMC336034

**3 Transfers**



AZ15164-10

AMC335259-AMC337099

**NO  
DOCUMENTS  
FOUND**

NO DOCUMENTS FOUND  
NO DOCUMENTS FOUND

**NOTICE!!**

**These documents have been scanned!**

**Do not place un-scanned documents beneath this notice!**

**Do not remove this notice from this file!**

GPO Jacket No. 560-102  
Print Order 61540  
Rise Business Services, LLC  
Job=AZ15 7/15/2019



Box Number= AZ15164



Claim Begin-End: AMC336027-AMC336034

**4 Annual Filings**



AZ15164-10

AMC335259-AMC337099



DEPARTMENT OF THE INTERIOR  
BUREAU OF LAND MANAGEMENT  
MINING CLAIMS

Run Date/Time: 8/16/2019

MC Maintenance Fees Paid Through the BLM Pay Portal  
(by Date Paid)

Page 77 Of 122

**CBS Receipt: 4530813**

Printed For Lead File # AMC336027

Agency Tracking ID: 1565644982

Assessment Year: 2020

Number of BLM Serial Nr: 14

Paid On: 8/12/2019

Total Amount Paid: \$2,310.00

Claim Name	BLM Serial No	Lead File No	Amount Paid
S M R #1	AMC300253	AMC300253	\$165.00
S M R #2	AMC300254	AMC300253	\$165.00
S M R #3	AMC300255	AMC300253	\$165.00
S M R #4	AMC300256	AMC300253	\$165.00
S M R #5	AMC300257	AMC300253	\$165.00
S M R #6	AMC300258	AMC300253	\$165.00
S M R #7	AMC300259	AMC300253	\$165.00
S M R #8	AMC300260	AMC300253	\$165.00
S M H #1	AMC336027	AMC336027	\$165.00
S M H #2	AMC336028	AMC336027	\$165.00
S M H #3	AMC336029	AMC336027	\$165.00
S M H #4	AMC336030	AMC336027	\$165.00
S M H #5	AMC336031	AMC336027	\$165.00
S M H #6	AMC336032	AMC336027	\$165.00

**United States Department of the Interior**  
**Bureau of Land Management**  
 BUSINESS & SUPPORT SVCS DIV  
 ONE N CENTRAL AVE SUITE 800  
 PHOENIX, AZ 85004 -4427  
 Phone: 602-417-9200

Receipt	
No:	4530813

<b>Transaction #:</b> 4651662	
<b>Date of Transaction:</b> 08/12/2019	
CUSTOMER:	
THOMAS O MILLS 4030 LEGATO LN EFLAND,NC 27243 US	

LINE #	QTY	DESCRIPTION	REMARKS	UNIT PRICE	TOTAL
1	1.00	LOCATABLE MINERALS / MINING CLAIMS- NOT NEW-UNADJUD,ONE AUTH NO. ONLY / MINING CLAIM MONEY RECEIVED <b>CASES: AMC300253/\$2310.00</b>		- n/a -	2310.00
<b>TOTAL:</b>					<b>\$2,310.00</b>

PAYMENT INFORMATION			
NOTE: Items will appear on credit card statement as "BLM O Mining Claim".			
1	AMOUNT:	2310.00	POSTMARKED: N/A
	TYPE:	CREDIT CARD	RECEIVED: 08/12/2019
	NAME:	THOMAS O MILLS 4030 LEGATO LN EFLAND NC 27243 US	
	CARD NO:	XXXXXXXXXXXX7402	AUTH CODE: 05268C
	NAME ON CARD:	THOMAS O MILLS	
	SIGNATURE:	INTERNET	

REMARKS

This receipt was generated by the automated BLM Collections and Billing System and is a paper representation of a portion of the official electronic record contained therein.

DEPARTMENT OF THE INTERIOR  
BUREAU OF LAND MANAGEMENT  
MINING CLAIMS

Run Date/Time: 8/20/2018

MC Maintenance Fees Paid Through the BLM Pay Portal  
(by Date Paid)

Page 267 Of 316

**CBS Receipt: 4237304**

Printed For Lead File # AMC336027

Agency Tracking ID: 1534440801

Assessment Year: 2019

Number of BLM Serial Nr: 14

Paid On: 8/16/2018

Total Amount Paid: \$2,170.00

Claim Name	BLM Serial No	Lead File No	Amount Paid
S M R #1	AMC300253	AMC300253	\$155.00
S M R #2	AMC300254	AMC300253	\$155.00
S M R #3	AMC300255	AMC300253	\$155.00
S M R #4	AMC300256	AMC300253	\$155.00
S M R #5	AMC300257	AMC300253	\$155.00
S M R #6	AMC300258	AMC300253	\$155.00
S M R #7	AMC300259	AMC300253	\$155.00
S M R #8	AMC300260	AMC300253	\$155.00
S M H #1	AMC336027	AMC336027	\$155.00
S M H #2	AMC336028	AMC336027	\$155.00
S M H #3	AMC336029	AMC336027	\$155.00
S M H #4	AMC336030	AMC336027	\$155.00
S M H #5	AMC336031	AMC336027	\$155.00
S M H #6	AMC336032	AMC336027	\$155.00

**United States Department of the Interior**

**Bureau of Land Management**  
 BUSINESS & SUPPORT SVCS DIV  
 ONE N CENTRAL AVE SUITE 800  
 PHOENIX, AZ 85004 -4427  
 Phone: 602-417-9200

Receipt

No: 4237304

<b>Transaction #:</b> 4352686	
<b>Date of Transaction:</b> 08/16/2018	
CUSTOMER:	
THOMAS O. MILLS 4030 LEGATO LANE EFLAND,NC 272439598 US	

LINE #	QTY	DESCRIPTION	REMARKS	UNIT PRICE	TOTAL
1	1.00	LOCATABLE MINERALS / MINING CLAIMS- NOT NEW-UNADJUD,ONE AUTH NO. ONLY / MINING CLAIM MONEY RECEIVED <b>CASES:</b> AMC300253/\$2170.00		- n/a -	2170.00
<b>TOTAL:</b>					<b>\$2,170.00</b>

PAYMENT INFORMATION			
NOTE: Items will appear on credit card statement as "BLM O Mining Claim".			
1	AMOUNT:	2170.00	POSTMARKED: N/A
	TYPE:	CREDIT CARD	RECEIVED: 08/16/2018
	NAME:	THOMAS O. MILLS 4030 LEGATO LANE EFLAND NC 272439598 US	
	CARD NO:	XXXXXXXXXXXX7402	AUTH CODE: 08746C
	NAME ON CARD:	THOMAS O. MILLS	
	SIGNATURE:		

REMARKS

This receipt was generated by the automated BLM Collections and Billing System and is a paper representation of a portion of the official electronic record contained therein.

Run Date: 08/21/17

Run Time: 09:47 AM

**DEPARTMENT OF THE INTERIOR  
BUREAU OF LAND MANAGEMENT  
MINING CLAIMS**

**MC Maintenance Fees Paid Through the BLM Pay Portal**

**CBS Receipt: 3936747**

Printed For Lead File # **AMC336027**

Agency Tracking ID: 1502729503

Number of BLM Serial Nr: 14

Assessment Year: 2018

Total Amount Paid: \$2,170.00

Paid On: 08/14/2017

Claim Name	BLM Serial No	Lead File No	Amount Paid
S M R #1	AMC300253	AMC300253	\$155.00
S M R #2	AMC300254	AMC300253	\$155.00
S M R #3	AMC300255	AMC300253	\$155.00
S M R #4	AMC300256	AMC300253	\$155.00
S M R #5	AMC300257	AMC300253	\$155.00
S M R #6	AMC300258	AMC300253	\$155.00
S M R #7	AMC300259	AMC300253	\$155.00
S M R #8	AMC300260	AMC300253	\$155.00
S M H #1	AMC336027	AMC336027	\$155.00
S M H #2	AMC336028	AMC336027	\$155.00
S M H #3	AMC336029	AMC336027	\$155.00
S M H #4	AMC336030	AMC336027	\$155.00
S M H #5	AMC336031	AMC336027	\$155.00
S M H #6	AMC336032	AMC336027	\$155.00

**United States Department of the Interior**  
**Bureau of Land Management**  
 BUSINESS & SUPPORT SVCS DIV  
 ONE N CENTRAL AVE SUITE 800  
 PHOENIX, AZ 85004 -4427  
 Phone: 602-417-9200

Receipt

No: 3936747

<b>Transaction #:</b> 4046371	
<b>Date of Transaction:</b> 08/14/2017	
<b>CUSTOMER:</b>	
THOMAS O. MILLS 4030 LEGATO LANE EFLAND,NC 27243 US	

LINE #	QTY	DESCRIPTION	REMARKS	UNIT PRICE	TOTAL
1	1.00	LOCATABLE MINERALS / MINING CLAIMS- NOT NEW-UNADJUD,ONE AUTH NO. ONLY / MINING CLAIM MONEY RECEIVED <b>CASES: AMC336032/\$2170.00</b>		- n/a -	2170.00
<b>TOTAL:</b>					<b>\$2,170.00</b>

PAYMENT INFORMATION			
NOTE: Items will appear on credit card statement as "BLM O Mining Claim".			
1	AMOUNT:	2170.00	POSTMARKED: N/A
	TYPE:	CREDIT CARD	RECEIVED: 08/14/2017
	NAME:	THOMAS O. MILLS 4030 LEGATO LANE EFLAND NC 27243 US	
	CARD NO:	XXXXXXXXXXXX1423	AUTH CODE: 02574C
	NAME ON CARD:	THOMAS O. MILLS	
	EXPIRES:	05/2019	
	SIGNATURE:		

<b>REMARKS</b>

This receipt was generated by the automated BLM Collections and Billing System and is a paper representation of a portion of the official electronic record contained therein.

336027

RECEIVED  
BLM AZ STATE OFFICE  
2016 AUG 15 P 3 01  
PHOENIX, ARIZONA

330253

Maintenance Fee Payment

Bureau Of Land Management  
Arizona State Office  
One North Central Avenue, Suite 800  
Phoenix, Arizona 85004-4427

August 11th, 2016

The Claims are located in Yavapai County, Arizona .

Sections 21 & 28 , T-12N R.-9W

BLM SERIAL NUMBERS

NAMES OF CLAIMS

AMC 336027 thru AMC 336032

Santa Maria Homestake (SMH) 1 - 6

AMC 300253 thru AMC 300260

Santa Maria River (SMR) 1 - 8

Claimant's Name: Thomas O. Mills

Address: 4030 Legato Lane, Efland, N. C. 27243-9598

Phone: 805-591-9298

Signature Thomas O. Mills

Date: 8-11-2016

RECEIPT # 3631895

ENTERED  
AUG 17 2016  
BY: Ram

Thomas Mills  
4030 Legato Lane  
Efland, N. C. 27243-9598

GREENSBORO, NC 27401  
PIEDMONT TRIAD AREA  
10 AUG 2016 PM 6 L

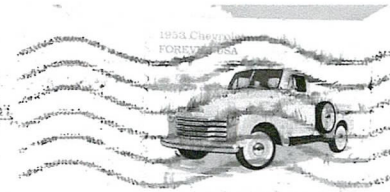

RECEIVED  
BLM AZ STATE OFFICE

2016 AUG 15 P 3:01

PHOENIX, ARIZONA

BUREAU OF LAND MANAGEMENT  
Arizona State Office  
One North Central Avenue, Suite 800  
Phoenix, Arizona 85004-4427

85004-442700

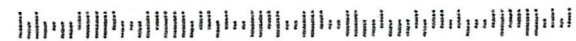



Thomas Mills  
4030 Legato Lane  
Efland, N. C. 27243-9598

GREENSBORO, NC 27411  
PIEDMONT TRIAD AREA  
10 AUG 2016 PM 6 L

1954 Chevrolet  
FOREVER USA



RECEIVED  
BLM AZ STATE OFFICE

2016 AUG 15 P 3:01

PHOENIX, ARIZONA

**BUREAU OF LAND MANAGEMENT**

Arizona State Office

One North Central Avenue, Suite 800

Phoenix, Arizona 85004-4427

85004-442700



**United States Department of the Interior**  
**Bureau of Land Management**  
 DIV OF LANDS, MINRLS & ENERGY  
 ONE N CENTRAL AVE  
 PHOENIX, AZ 85004 -4427  
 Phone: 602-417-9200

Receipt

No: 3631895

<b>Transaction #:</b> 3735702	
<b>Date of Transaction:</b> 08/16/2016	
CUSTOMER:	
THOMAS MILLS 4030 LEGATO LN EFLAND,NC 27243-9598 US	

LINE #	QTY	DESCRIPTION	REMARKS	UNIT PRICE	TOTAL
1	1.00	LOCATABLE MINERALS / MINING CLAIMS- NOT NEW-UNADJUD,ONE AUTH NO. ONLY / MINING CLAIM MONEY RECEIVED CASES: AMC336027/\$2170.00	MAINT FEE 2017 - 14	- n/a -	2170.00
<b>TOTAL:</b>					<b>\$2,170.00</b>

PAYMENT INFORMATION			
1	AMOUNT:	2170.00	POSTMARKED: 08/10/2016
	TYPE:	CHECK	RECEIVED: 08/15/2016
	CHECK NO:	1703	
	NAME:	MILLS, THOMAS O 4030 LEGATO LN EFLAND NC 27243-9598 US	

REMARKS

This receipt was generated by the automated BLM Collections and Billing System and is a paper representation of a portion of the official electronic record contained therein.

336027  
300253

Maintenance Fee Payment

Bureau Of Land Management  
Arizona State Office  
One North Central Avenue, Suite 800  
Phoenix, Arizona 85004-4427

August 6th, 2015

The Claims are located in Yavapai County, Arizona .

Sections 21 & 28 , T-12N R.-9W

BLM SERIAL NUMBERS

NAMES OF CLAIMS

AMC 336027 thru AMC 336032

Santa Maria Homestake (SMH) 1 - 6

AMC 300253 thru AMC 300260

Santa Maria River (SMR) 1 - 8

Claimant's Name: Thomas O. Mills

Address: 1754 Brahma Street, Paso Robles, California 93446

Phone: 805-591-9298

RECEIPT # 33604311

Signature Thomas O. Mills

Date: 8-6-2015

RECEIVED  
BLM ATTORNEY OFFICE  
2015 AUG 10 P 3:23  
PHOENIX, ARIZONA

ENTERED  
AUG 18 2015  
BY: RE

Bureau Of Land Management  
Arizona State Office  
One North Central Avenue, Suite 800  
Phoenix, Arizona 85004-4427

August 6h, 2015

Dear Sir,

I would like to pay my maintenance fee with my credit card.

The claims are located in Yavapai County, Arizona.

Sections 21 & 28, T-12N R-9W

BLM Serial Numbers

AMC 336027 through AMC 336032 Santa Maria Homestake (SMH) 1 - 6

AMC 300253 through AMC 300260 Santa Maria River (SMR) 1 - 8

14 claims X \$155.00 = \$2,170.00

Thomas O. Mills  
1754 Brahma Street  
Paso Robles, CA. 93446

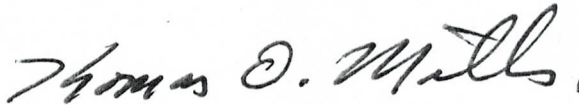

805-591-9298

[tmills1870@aol.com](mailto:tmills1870@aol.com)

Thank You

RECEIVED  
BLM AZ STATE OFFICE  
2015 AUG 10 P 3:23  
PHOENIX, ARIZONA

T.O. Mills  
1754 BRAHMA ST.  
PASO ROBLES, CA

SANTA BARBARA  
CA 931  
06 AUG 2015 PM 3 T



RECEIVED  
93446  
POST OFFICE

2015 AUG 10 P 3:23

PHOENIX, ARIZONA

BUREAU OF LAND MANAGEMENT  
ONE N. Central Ave.  
Suite 800  
Phoenix, ARIZONA

85004

85004+4427

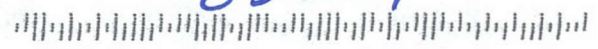

**United States Department of the Interior**  
**Bureau of Land Management**  
LANDS/RECREATION & PLANNING  
ONE N CENTRAL AVE  
PHOENIX, AZ 85004 -2203  
Phone: 602-417-9200

Receipt

No: 3364311

<b>Transaction #:</b> 3462354	
<b>Date of Transaction:</b> 08/11/2015	
CUSTOMER:	
THOMAS MILLS 1754 BRAHMA ST PASO ROBLES, CA 93446-4664 US	

LINE #	QTY	DESCRIPTION	REMARKS	UNIT PRICE	TOTAL
1	1.00	LOCATABLE MINERALS / MINING CLAIMS-NOT NEW-UNADJUD, ONE AUTH NO. ONLY / MINING CLAIM MONEY RECEIVED CASES: AMC336027/\$2170.00	MAINT FEE PYMNT (14) 2016	- n/a -	2170.00
<b>TOTAL:</b>					<b>\$2,170.00</b>

PAYMENT INFORMATION			
NOTE: Items will appear on credit card statement as "Bureau of Land Mgmt CO".			
1	AMOUNT:	2170.00	POSTMARKED: N/A
	TYPE:	CREDIT CARD	RECEIVED: 08/10/2015
	NAME:	MILLS, THOMAS 1754 BRAHMA ST PASO ROBLES CA 93446-4664 US	
	CARD NO:	XXXXXXXXXXXX4610	AUTH CODE: 09696D
	NAME ON CARD:	THOMAS O MILLS	
	EXPIRES:	07/2018	
	SIGNATURE:		

REMARKS

This receipt was generated by the automated BLM Collections and Billing System and is a paper representation of a portion of the official electronic record contained therein.

300253

336027

Maintenance Fee Payment

Bureau Of Land Management  
Arizona State Office  
One North Central Avenue, Suite 800  
Phoenix, Arizona 85004-4427

August 6th, 2014

The Claims are located in Yavapai County, Arizona .

Sections 21 & 28 , T-12N R.-9W

BLM SERIAL NUMBERS

NAMES OF CLAIMS

AMC 336027 thru AMC 336032

Santa Maria Homestake (SMH) 1 - 6

AMC 300253 thru AMC 300260

Santa Maria River (SMR) 1 - 8

Claimant's Name: Thomas O. Mills

Address: 1754 Brahma Street, Paso Robles, California 93446

Phone: 805-591-9298

Signature Thomas O. Mills

Date: 8-6-2014

ENTERED  
AUG 14 2014  
BY: RE

RECEIVED  
BLM AZ STATE OFFICE  
2014 AUG - 8 P 2:33  
PHOENIX, ARIZONA

# 3097749

**United States Department of the Interior**  
**Bureau of Land Management**  
 LANDS/RECREATION & PLANNING  
 ONE N CENTRAL AVE  
 PHOENIX, AZ 85004 -2203  
 Phone: 602-417-9200

Receipt

No: 3097749

<b>Transaction #:</b> 3189263	
<b>Date of Transaction:</b> 08/11/2014	
<b>CUSTOMER:</b>	
THOMAS MILLS 1754 BRAHMA ST PASO ROBLES, CA 93446-4664 US	

LINE #	QTY	DESCRIPTION	REMARKS	UNIT PRICE	TOTAL
1	1.00	LOCATABLE MINERALS / MINING CLAIMS- NOT NEW-UNADJUD, ONE AUTH NO. ONLY / MINING CLAIM MONEY RECEIVED CASES: AMC336027/\$2170.00	MAINT 2015/14	- n/a -	2170.00
<b>TOTAL:</b>					<b>\$2,170.00</b>

PAYMENT INFORMATION					
1	AMOUNT:	2170.00	POSTMARKED:	08/07/2014	
	TYPE:	CHECK	RECEIVED:	08/08/2014	
	CHECK NO:	1393			
	NAME:	MILLS, THOMAS O 1754 BRAHMA ST PASO ROBLES CA 93446-4664 US			

<b>REMARKS</b>

This receipt was generated by the automated BLM Collections and Billing System and is a paper representation of a portion of the official electronic record contained therein.



300253  
336027

Maintenance Fee Payment

Bureau Of Land Management  
Arizona State Office  
One North Central Avenue, Suite 800  
Phoenix, Arizona 85004-4427

August 15~~th~~, 2013

The Claims are located in Yavapai County, Arizona .

Sections 21 & 28 , T-12N R.-9W

BLM SERIAL NUMBERS

NAMES OF CLAIMS

AMC 336027 thru AMC 336032

Santa Maria Homestake (SMH) 1 - 6

AMC 300253 thru AMC 300260

Santa Maria River (SMR) 1 - 8

Claimant's Name: Thomas O. Mills

Address: 1754 Brahma Street, Paso Robles, California 93446

Phone: 805-591-9298

Signature

Thomas O. Mills

Date:

8-1-2013

PROCESSED  
2013 AUG -5 PM 2:30  
BLM-ASO

NO. OF CLAIMS

14

AMOUNT

\$1960.00

RECEIPT NO:

2847742

INIT.

AM

\*\* BLM-ASO\*\*

RE 8-13-13  
ENTERED IN COMPUTER

**Thomas Mills**  
1754 Brahma St  
Paso Robles, CA 93446-4664

SANTA BARBARA  
CA 931 2 L  
01 AUG 2013 PM



RECEIVED  
DLN /

2013 AUG -5 PM 2:52

PHOENIX, ARIZONA  
BUREAU OF LAND MANAGEMENT  
ARIZONA STATE OFFICE  
ONE N. Central Ave  
Suite 800  
Phoenix, ARIZONA

85004+4427

0500 1111 11427

**United States Department of the Interior**  
**Bureau of Land Management**  
 LANDS/RECREATION & PLANNING  
 ONE N CENTRAL AVE  
 PHOENIX, AZ 85004 -2203  
 Phone: 602-417-9200

Receipt

No: 2847742

<b>Transaction #:</b> 2933433	
<b>Date of Transaction:</b> 08/06/2013	
CUSTOMER:	
THOMAS MILLS 1754 BRAHMA ST PASO ROBLES, CA 93446-4664 US	

LINE #	QTY	DESCRIPTION	REMARKS	UNIT PRICE	TOTAL
1	1.00	LOCATABLE MINERALS / MINING CLAIMS-NOT NEW-UNADJUD, ONE AUTH NO. ONLY / MINING CLAIM MONEY RECEIVED CASES: AMC336027/\$1960.00	MAINT FEE PYMNT (14) 2014	- n/a -	1960.00
<b>TOTAL:</b>					<b>\$1,960.00</b>

PAYMENT INFORMATION					
1	AMOUNT:	1960.00	POSTMARKED:	08/01/2013	
	TYPE:	CHECK	RECEIVED:	08/05/2013	
	CHECK NO:	1211			
	NAME:	MILLS, THOMASO 1754 BRAHMA ST PASO ROBLES CA 93446-4664 US			

REMARKS

This receipt was generated by the automated BLM Collections and Billing System and is a paper representation of a portion of the official electronic record contained therein.

Amc 336027

300253

Maintenance Fee Payment

Bureau Of Land Management  
Arizona State Office  
One N. Central Avenue Suite 800  
Phoenix, Arizona 85004-4427

August 15, 2012

The Claims are located in Yavapai County, Arizona .

Sections 21 & 28 , T-12N R.-9W

BLM SERIAL NUMBERS

NAMES OF CLAIMS

AMC 336027 thru AMC 336032

Santa Maria Homestake (SMH) 1 - 6

AMC 300253 thru AMC 300260

Santa Maria River (SMR) 1 - 8

Claimant's Name: Thomas O. Mills

Address: 1754 Brahma Street, Paso Robles, California 93446

Phone: 805-591-9298

Signature Thomas O. Mills

Date: 8-15-2012

NO. OF CLAIMS 14  
AMOUNT \$1960.<sup>00</sup>  
RECEIPT NO. 2635507  
INIT. OAD

\*\* BLM-ASO\*\*

RECEIVED  
BLM AZ STATE OFFICE  
2012 AUG 20 A 10:34  
PHOENIX, ARIZONA

ENTERED INTO COMPUTER

8/31/12 AT

Tom & GiGi Mills  
1754 Brahma Street  
Paso Robles, CA 93446

BLTM  
ARIZONA STATE OFFICE  
ONE N. CENTRAL AVE  
SUITE 800  
PHOENIX, ARIZONA

85004-4427



RECEIVED  
BLM AZ STATE OFFICE  
PHOENIX, ARIZONA

2012 AUG 20 A 10:34

Tom & GiGi Mills  
1754 Brahma Street  
Paso Robles, CA 93446

BLM  
ARIZONA STATE OFFICE  
ONE N. CENTRAL AVE  
Suite 800  
Phoenix, ARIZONA



RECEIVED  
BLM AZ STATE OFFICE  
2012 AUG 20 A 10:34  
PHOENIX, ARIZONA

85004-4427



Fla  
Ap

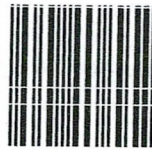

1006

85004

U.S. POSTAGE  
PAID  
PASO ROBLES, CA  
93446  
AUG 15, 12  
AMOUNT

**\$5.45**  
00013334-11

United States Postal Service®  
**DELIVERY CONFIRMATION™**

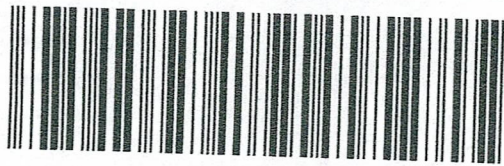

0311 3260 0001 8710 6025

RECEIVED  
ALH AZ STATE OFFICE  
AUG 20 A 10 34  
PRINEN, ARIZONA

EP14H JAN 2011 Outer Dimension: 10 x 5

**United States Department of the Interior**  
**Bureau of Land Management**  
 LANDS/RECREATION & PLANNING  
 ONE N CENTRAL AVE  
 PHOENIX, AZ 85004 -2203  
 Phone: 602-417-9200

Receipt

No: 2635507

<b>Transaction #:</b> 2716079	
<b>Date of Transaction:</b> 08/21/2012	
<b>CUSTOMER:</b>	
THOMAS MILLS 1754 BRAHMA ST PASO ROBLES, CA 93446-4664 US	

**ENTERED INTO COMPUTER**

LINE #	QTY	DESCRIPTION	REMARKS	UNIT PRICE	TOTAL
1	1.00	LOCATABLE MINERALS / MINING CLAIMS-NOT NEW-UNADJUD, ONE AUTH NO. ONLY / MINING CLAIM MONEY RECEIVED <b>CASES: AMC336027/\$1960.00</b>	MAINT FEE PYMNT (14) 2013	- n/a -	1960.00
<b>TOTAL:</b>					<b>\$1,960.00</b>

PAYMENT INFORMATION			
1	AMOUNT:	1960.00	POSTMARKED: N/A
	TYPE:	CHECK	RECEIVED: 08/20/2012
	CHECK NO:	110	
	NAME:	MILLS, THOMAS 1754 BRAHMA ST PASO ROBLES CA 93446-4664 US	

<b>REMARKS</b>	

This receipt was generated by the automated BLM Collections and Billing System and is a paper representation of a portion of the official electronic record contained therein.

*Lead Amc #18 (B)*  
*Amc 336027*  
*300253*



Amc 336027

Amc 300253

Maintenance Fee Payment

Bureau Of Land Management  
Arizona State Office  
One North Central Avenue, Suite 800  
Phoenix, Arizona 85004-4427

August 11th, 2011

The Claims are located in Yavapai County, Arizona .

Sections 21 & 28 , T-12N R.-9W

BLM SERIAL NUMBERS

NAMES OF CLAIMS

✓ AMC 336027 thru AMC 336032

Santa Maria Homestake (SMH) 1 - 6

✓ AMC 300253 thru AMC 300260

Santa Maria River (SMR) 1 - 8

Claimant's Name: Thomas O. Mills

Address: 1754 Brahma Street, Paso Robles, California 93446

Phone: 805-591-9298 Fax-805-286-4296

Signature

*Thomas O. Mills*

Date:

*8-11-2011*

PHOENIX, ARIZONA

2011 AUG 16 A 7:49

RECEIVED  
BLM AZ STATE OFFICE

NO. OF CLAIMS

*14*

AMOUNT

*19160.00*

RECEIPT NO.

*2405999*

•INIT:

*SPJ*

\*\* BLM-ASO\*\*

AUG 17 2011 *cm*

**United States Department of the Interior**  
**Bureau of Land Management**  
 LANDS/RECREATION & PLANNING  
 ONE N CENTRAL AVE  
 PHOENIX, AZ 85004 -2203  
 Phone: 602-417-9200

Receipt

No:

2405999

<b>Transaction #:</b> 2481265	
<b>Date of Transaction:</b> 08/16/2011	
CUSTOMER:	
THOMAS MILLS 1754 BRAHMA ST PASO ROBLES,CA 93446-4664 US	

LINE #	QTY	DESCRIPTION	REMARKS	UNIT PRICE	TOTAL
1	1.00	LOCATABLE MINERALS / MINING CLAIMS-NOT NEW-UNADJUD,ONE AUTH NO. ONLY / MINING CLAIM MONEY RECEIVED CASES: AMC336027/\$1960.00	MAINT-14	- n/a -	1960.00
<b>TOTAL:</b>					<b>\$1,960.00</b>

PAYMENT INFORMATION					
1	AMOUNT:	1960.00	POSTMARKED:	08/11/2011	
	TYPE:	CHECK	RECEIVED:	08/16/2011	
	CHECK NO:	1179			
	NAME:	MILLS, THOMAS O 1754 BRAHMA ST PASO ROBLES CA 93446-4664 US			

REMARKS

This receipt was generated by the automated BLM Collections and Billing System and is a paper representation of a portion of the official electronic record contained therein.

T.O.M:lls  
1754 BRAHMA STREET  
Paso Robles, CA  
93446

SANTA BARBARA  
CA 931 2 T  
11 AUG 2011 PM



RECEIVED  
BLM AZ STATE OFFICE

2011 AUG 15 P 1:30

PHOENIX, ARIZONA

BLM  
ARIZONA STATE OFFICE  
ONE NORTH Central  
Suite 800  
Phoenix, ARIZONA

85004+4427

85004-4427



AMC 336027  
AMC 300253

Maintenance Fee Payment

Bureau Of Land Management  
Arizona State Office  
One North Central Avenue, Suite 800  
Phoenix, Arizona 85004-4427

August 13th, 2010

The Claims are located in Yavapai County, Arizona .

Sections 21 & 28 , T-12N R.-9W

BLM SERIAL NUMBERS

NAMES OF CLAIMS

AMC 336027 thru AMC 336032

Santa Maria Homestake (SMH) 1 - 6

AMC 300253 thru AMC 300260

Santa Maria River (SMR) 1 - 8

Claimant's Name: Thomas O. Mills

Address: 1754 Brahma Street, Paso Robles, California 93446

Phone: 805-591-9298 Fax-805-286-4296

Signature Thomas O. Mills

Date: August 13th, 2010

RECEIVED  
BLM AZ STATE OFFICE  
2010 AUG 18 A 10:11  
PHOENIX, ARIZONA

ENTERED INTO COMPUTER  
*no*

AUG 25 2010

NO. OF CLAIMS 14  
AMOUNT \$1960.00  
RECEIPT NO. 2193645  
INIT. act

\*\* BLM-ASO \*\*

**United States Department of the Interior**  
**Bureau of Land Management**  
 LANDS/RECREATION & PLANNING  
 ONE N CENTRAL AVE  
 PHOENIX, AZ 85004 -2203  
 Phone:

Receipt

No: **2193645**

<b>Transaction #:</b> 2263454		<b>ENTERED INTO COMPUTER</b>
<b>Date of Transaction:</b> 08/18/2010		
<b>CUSTOMER:</b>	THOMAS MILLS 1754 BRAHMA ST PASO ROBLES, CA 93446-4664 US	<b>AUG 25 2010</b>

LINE #	QTY	DESCRIPTION	REMARKS	UNIT PRICE	TOTAL
1	1.00	LOCATABLE MINERALS / MINING CLAIMS-NOT NEW-UNADJUD, ONE AUTH NO. ONLY / MINING CLAIM MONEY RECEIVED <b>CASES: AMC336027/\$1960.00</b>	MAINT FEE PYMNT (14) 2011	- n/a -	1960.00
<b>TOTAL:</b>					<b>\$1,960.00</b>

PAYMENT INFORMATION			
1	<b>AMOUNT:</b>	1960.00	<b>POSTMARKED:</b> N/A
	<b>TYPE:</b>	CHECK	<b>RECEIVED:</b> 08/18/2010
	<b>CHECK NO:</b>	1133	
	<b>NAME:</b>	MILLS, THOMAS 1754 BRAHMA ST PASO ROBLES CA 93446-4664 US	

REMARKS

This receipt was generated by the automated BLM Collections and Billing System and is a paper representation of a portion of the official electronic record contained therein.

AMC 336027  
300 253

RECEIVED  
BLM AZ STATE OFFICE

2009 AUG 13 A 8:22

PHOENIX, ARIZONA

Maintenance Fee Payment

Bureau Of Land Management  
Arizona State Office  
One North Central Avenue, Suite 800  
Phoenix, Arizona 85004-4427

August 10th, 2009

The Claims are located in Yavapai County, Arizona .

Sections 21 & 28 , T-12N R.-9W

BLM SERIAL NUMBERS

NAMES OF CLAIMS

AMC 336027 thru AMC 336032

Santa Maria Homestake (SMH) 1 - 6

AMC 300253 thru AMC 300260

Santa Maria River (SMR) 1 - 8

Claimant's Name: Thomas O. Mills

Address: 1754 Brahma Street, Paso Robles, California 93446

Phone: 805-591-9298 Fax-805-286-4296

Signature Thomas O. Mills

Date: 8-10-2009

ENTERED  
AUG 28 2009  
299

2009  
AUG 10 10:49 AM  
299

**United States Department of the Interior**  
**Bureau of Land Management**  
 BUSINESS & SUPPORT SVCS DIV  
 ONE N CENTRAL AVE SUITE 800  
 PHOENIX, AZ 85004 -4427  
 Phone: (602) 417-9200

Receipt

No: 1977306

<b>Transaction #:</b> 2041292	
<b>Date of Transaction:</b> 08/13/2009	
<b>CUSTOMER:</b>	THOMAS MILLS 1754 BRAHMA ST PASO ROBLES,CA 93446-4664 US

LINE #	QTY	DESCRIPTION	REMARKS	UNIT PRICE	TOTAL
1	1.00	LOCATABLE MINERALS / MINING CLAIMS-NOT NEW-UNADJUD,ONE AUTH NO. ONLY / MINING CLAIM MONEY RECEIVED <b>CASES: AMC336027/\$1960.00</b>	MAINT 2010	- n/a -	1960.00
<b>TOTAL:</b>					<b>\$1,960.00</b>

PAYMENT INFORMATION					
1	AMOUNT:	1960.00	POSTMARKED:	08/10/2009	
	TYPE:	CHECK	RECEIVED:	08/13/2009	
	CHECK NO:	1083			
	NAME:	MILLS, THOMAS O 1754 BRAHMA ST PASO ROBLES CA 93446-4664 US			

REMARKS

This receipt was generated by the automated BLM Collections and Billing System and is a paper representation of a portion of the official electronic record contained therein.

AMC 336027

AMC 300253

Maintenance Fee Payment

Bureau Of Land Management  
Arizona State Office  
222 North Central Avenue  
Phoenix, Arizona 85004-2203

Fax 602-417-9314

The Claims are located in Yavapai County, Arizona .

Sections 21 & 28 , T-12N R.-91W

BLM SERIAL NUMBERS

AMC 336027 thru AMC 336032 (4)

AMC 300253 thru AMC 300260 (8)

Claimant's Name: Thomas O Mills

Address: 1754 Brahma Street, Paso Robles, California 93146

Phone: 805-591-9298 Fax-805-227-1574

Signature Thomas O. Mills

Date: 8-11-2008

NAMES OF CLAIMS

Santa Maria Homestake (SMH) 1 - 6

Santa Maria River (SMR) 1 - 8

PHOENIX, ARIZONA

2008 AUG 12 A 9: 59

B.L.M. RECEIVED  
AZ STATE OFFICE

14/50

ENTERED INTO COMPUTER

ENTERED INTO COMPUTER

9/2/08 [Signature]



# Complimentary Self-Serve Fax Cover Sheet

To: SUSAN

Fax #: 602-417-9314

Date: 8-11-2008

Number of Pages (Including Cover):

From: Tom Mills

Phone #: 805-591-9298

Reply Fax #: 805-227-1574

Urgent  Confidential  Confirm Receipt

**We'll do it right the first time — guaranteed.**

Black & white copies • Color copies • Custom printing • Binding • Folding • Wide-format copying • Custom stamps • UPS shipping and more

that was easy.

5/06btzev\_009815

RECEIVED  
B.L.M. AZ STATE OFFICE  
2008 AUG 12 A 9:59  
PHOENIX, ARIZONA

**United States Department of the Interior**  
**Bureau of Land Management**  
 BUSINESS & SUPPORT SVCS DIV  
 ONE N CENTRAL AVE SUITE 800  
 PHOENIX, AZ 85004 -4427  
 Phone: (602) 417-9200

Receipt

No: 1761575

<b>Transaction #:</b> 1819109	
<b>Date of Transaction:</b> 08/14/2008	
<b>CUSTOMER:</b>	THOMAS MILLS 1754 BRAHMA ST PASO ROBLES,CA 93446

LINE #	QTY	DESCRIPTION	REMARKS	UNIT PRICE	TOTAL
1	1.00	LOCATABLE MINERALS / MINING CLAIMS-NOT NEW-UNADJUD,ONE AUTH NO. ONLY / MINING CLAIM MONEY RECEIVED (455) CASES: AMC336027/\$1750.00	MAINT 2009 (14)	- n/a -	1750.00
<b>TOTAL:</b>					<b>\$1,750.00</b>

PAYMENT INFORMATION			
NOTE: Items will appear on credit card statement as "Bureau of Land Mgmt CO".			
1	AMOUNT:	\$1,750.00	POSTMARKED: N/A
	TYPE:	CREDIT CARD	RECEIVED: 08/14/2008
	NAME:	MILLS, THOMAS 1754 BRAHMA ST PASO ROBLES CA 93446	
	CARD NO:	XXXXXXXXXXXX5806	AUTH CODE: 16449Z
	NAME ON CARD:	THOMAS MILLS	
	EXPIRES:	10/31/2010	
	SIGNATURE:		

REMARKS

This receipt was generated by the automated BLM Collections and Billing System and is a paper representation of a portion of the official electronic record contained therein.



Fte
\$ 5
\$8
\$5
\$4
\$ 19/10/07

Recorded at the request of:

When Recorded, MAIL TO:

AMC 336027  
AMC 300253

Already entered. Copy with County recorder info on it.  
AB



State of Arizona  
Affidavit and Statement of Annual Labor and Assessment  
Work for the Year Ending September 1<sup>st</sup>, 2007

State of Arizona     )  
  :  
County of Yavapai    )

**THE UNDERSIGNED, whose current mailing address is 1754 Brahma Street, Paso Robles, Calif. 93446, being first duly sworn, deposes and says that at least One Hundred dollars (\$100.00) worth of labor and assessment work year ending at 12:00 Meridian on the 1<sup>st</sup> day of September 2007, on or for the benefit of a contiguous group of 14 unpatented lode claims described on Exhibit "A" attached hereto and made apart hereof for this reference.**

**That labor was performed or improvements made during the period from September 1, 2006 to September 1, 2007, by Thomas O. Mills.**

**An amount in excess of \$2,000 was spent for said labor and improvements which consisted of road and repair work.**

**IN WITNESS WHEREOF, this instrument is executed as of this**  
16<sup>th</sup> day of August, 2007.

By: Thomas O. Mills  
Thomas O. Mills

**The foregoing instrument was subscribed and sworn before me this**  
this 16<sup>th</sup> day of August, 2007, by Thomas O. Mills.

**My commission Expires:** June 7, 2011.

**Notary Public Residing In** San Luis Obispo County

**SEAL**

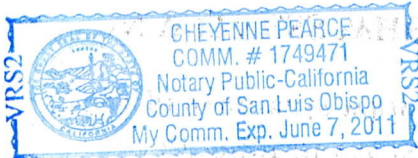



August 15, 2007

Yavapai County Recorder  
1015 Fair St.  
Prescott, Arizona 86301

EXHIBIT "A"

Dear Sir,

This Document reflects my intent to hold the following mining claims located in T\_12N. 9W, Sections 21 & 28.

- SMR.....#1.....AMC#300253
- SMR.....#2.....AMC#300254
- SMR.....#3.....AMC#300255
- SMR.....#4.....AMC#300256
- SMR.....#5.....AMC#300257
- SMR.....#6.....AMC#300258
- SMR.....#7.....AMC#300259
- SMR.....#8.....AMC#300260

*lead  
Amc 300253*

- SMH.....#1.....AMC#336027
- SMH.....#2.....AMC#336028
- SMH.....#3.....AMC#336029
- SMH.....#4.....AMC#336030
- SMH.....#5.....AMC#336031
- SMH.....#6.....AMC#336032

*lead  
336027*

My name is Thomas O. Mills and my address is 1754 Brahma Street, Paso Robles, Calif. 93446, phone 805-591-9298, Santa Maria Enterprises, Inc.

SMR is an abbreviation for Santa Maria River and SMH stands for Santa Maria Homestake.

Thank you,  
*Thomas O. Mills*  
Thomas O. Mills  
Santa Maria Enterprises, Inc.

United States Department of the Interior  
 Bureau of Land Management  
 BUSINESS & SUPPORT SVCS DIV  
 ONE N CENTRAL AVE SUITE 800  
 PHOENIX, AZ 85004 -4427  
 Phone: (602) 417-9200

Receipt

No: 1541350

<b>Transaction #:</b> 1592690	
<b>Date of Transaction:</b> 08/10/2007	
<b>CUSTOMER:</b>	THOMAS MILLS 1754 BRAHMA ST PASO ROBLES, CA 93446

LINE #	QTY	DESCRIPTION	REMARKS	UNIT PRICE	TOTAL
1	1.00	LOCATABLE MINERALS / MINING CLAIMS-NOT NEW-UNADJUD, ONE AUTH NO. ONLY / MINING CLAIM MONEY RECEIVED (455) CASES: AMC336027/\$1750.00	MAINT 2008 (14)	- n/a -	1750.00
<b>TOTAL:</b>					<b>\$1,750.00</b>

PAYMENT INFORMATION					
NOTE: Items will appear on credit card statement as "Bureau of Land Management".					
1	AMOUNT:	\$1,750.00	POSTMARKED:	N/A	
	TYPE:	CREDIT CARD	RECEIVED:	08/10/2007	
	NAME:	MILLS, THOMAS 1754 BRAHMA ST PASO ROBLES CA 93446			
	CARD NO:	XXXXXXXXXXXX5806	AUTH CODE:	551826	
	NAME ON CARD:	THOMAS MILLS			
	EXPIRES:	10/31/2007			
	SIGNATURE:				

REMARKS

This receipt was generated by the automated BLM Collections and Billing System and is a paper representation of a portion of the official electronic record contained therein.



B-4532 P-748  
 Page: 4 of 5  
 ADL 4166135



Maintenance Fee Payment

Bureau Of Land Management  
Arizona State Office  
222 North Central Avenue  
Phoenix, Arizona 85004-2203

Fax 602-417-9556

The Claims are located in Yavapai County, Arizona .

Sections 21 & 28 , T-12N R-10W

BLM SERIAL NUMBERS

NAMES OF CLAIMS

AMC 336027 thru AMC 336032

Santa Maria Homestake (SMH) 1-6

AMC 300253 thru AMC 300260

Santa Maria River (SMR) 1-8

Claimant's Name: Thomas D. Mills

Address: 1754 Brahma Street, Paso Robles, California 93446

Phone: 805-591-9298

Signature Thomas O. Mills

Date: Aug 9th, 2007

*Thomas O. Mills*

RECEIVED  
B.L.M. AZ STATE OFFICE  
2007 AUG 10 P 12:52  
PHOENIX, ARIZONA

RECORDERS MEMO: LEGIBILITY  
QUESTIONABLE FOR GOOD REPRODUCTION

AMC 336027-  
300253-

Maintenance Fee Payment

Bureau Of Land Management  
Arizona State Office  
222 North Central Avenue  
Phoenix, Arizona 85004-2203

Fax 602-417-9556

The Claims are located in Yavapai County, Arizona .

Sections 21 & 28 , T-12N R.-10W

BLM SERIAL NUMBERS

AMC 336027 thru AMC 336032

AMC 300253 thru AMC 300260

NAMES OF CLAIMS

Santa Maria Homestake (SMH) / - 6

Santa Maria River (SMR) / - 8

Claimant's Name: Thomas J. Mills

Address: 1754 Brahma Street, Paso Robles, California 93446

Phone: 805-591-9298

Signature Thomas J. Mills

Date: Aug 9th, 2007

RECEIVED  
B.L.M. AZ STATE OFFICE  
2007 AUG 10 P 12: 52  
PHOENIX, ARIZONA

ENTERED INTO COMPUTER  
9/10/07 DJJ



## Complimentary Self-Serve Fax Cover Sheet

To: MR. Tony Smith

Fax#: 602-417-9556

Date: 8-9-2007

Number of Pages:  
(Including Cover)

From: T. O. Mills

Phone#: ( 805-591-9298 )

Urgent  Confidential  Confirm Receipt

Reply Fax #:

RECEIVED  
B.L.M. AZ STATE OFFICE  
2007 AUG 10 P 12: 52  
PHOENIX, ARIZONA

**We'll do it right the first time – guaranteed.**

Staples® Copy & Print Centers offer print shop services and one-stop convenience. Choose from:

Black & white copies • Color copies • Custom printing • Binding • Folding • Wide-format copying • Custom stamps • UPS shipping and more

**that was easy.**<sup>sm</sup>

7/05h25v\_003218

United States Department of the Interior  
 Bureau of Land Management  
 BUSINESS & SUPPORT SVCS DIV  
 ONE N CENTRAL AVE SUITE 800  
 PHOENIX, AZ 85004 -4427  
 Phone: (602) 417-9200

Receipt

No: 1541350

<b>Transaction #:</b> 1592690	
<b>Date of Transaction:</b> 08/10/2007	
<b>CUSTOMER:</b>	THOMAS MILLS 1754 BRAHMA ST PASO ROBLES, CA 93446

LINE #	QTY	DESCRIPTION	REMARKS	UNIT PRICE	TOTAL
1	1.00	LOCATABLE MINERALS / MINING CLAIMS-NOT NEW-UNADJUD, ONE AUTH NO. ONLY / MINING CLAIM MONEY RECEIVED (455) CASES: AMC336027/\$1750.00	MAINT 2008 (14)	- n/a -	1750.00
<b>TOTAL:</b>					<b>\$1,750.00</b>

PAYMENT INFORMATION			
NOTE: Items will appear on credit card statement as "Bureau of Land Management".			
1	AMOUNT:	\$1,750.00	POSTMARKED: N/A
	TYPE:	CREDIT CARD	RECEIVED: 08/10/2007
	NAME:	MILLS, THOMAS 1754 BRAHMA ST PASO ROBLES CA 93446	
	CARD NO:	XXXXXXXXXXXX5806	AUTH CODE: 551826
	NAME ON CARD:	THOMAS MILLS	
	EXPIRES:	10/31/2007	
	SIGNATURE:		

REMARKS

This receipt was generated by the automated BLM Collections and Billing System and is a paper representation of a portion of the official electronic record contained therein.

AMC 336027

AMC 300253

**Maintenance Fee Payment**

**Bureau Of Land management  
Arizona State Office  
222 North Central Avenue  
Phoenix, Arizona 85004-2203 FAX 602-417-9314**

**The Claims are situated in Yavapai County, Arizona**

<b>BLM SERIAL NUMBERS</b>	<b>NAMES OF CLAIMS</b>
<b>AMC 336027 thru AMC 336032<sup>6</sup></b>	<b>SMH (Santa Maria Homestake)</b>
<b>AMC 300253 thru AMC 300260<sup>8</sup></b>	<b>SMR (Santa Maria River)</b>

**CLAIMANT'S NAME Thomas O. Mills**

**ENTERED INTO COMPUTER  
AUG 11 2006 PB**

**ADDRESS 1754 Brahma Street, Paso Robles, California 93446**

**PHONE 805-591-9298**

**SIGNATURE Thomas O. Mills**

**DATE 8-9-2006**

PHOENIX, ARIZONA

2006 AUG - 9 P 12: 16

RECEIVED  
B.L.M. AZ STATE OFFICE

14  
TMC

**United States Department of the Interior**  
**Bureau of Land Management**  
 BUSINESS & SUPPORT SVCS DIV  
 ONE N CENTRAL AVE  
 PHOENIX, AZ 85004 -2203  
 Phone: (602) 417-9200

Receipt

No: 1330594

Transaction #: 1375625		<b>ENTERED INTO COMPUTER</b> AUG 11 2006 <i>AB</i>
Date of Transaction: 08/09/2006		
CUSTOMER:	THOMAS O MILLS 1754 BRAHMA ST PASO ROBLES, CA 93446	

LINE #	QTY	DESCRIPTION	REMARKS	UNIT PRICE	TOTAL
1	1.00	LOCATABLE MINERALS / MINING CLAIMS-NOT NEW-UNADJUD, ONE AUTH NO. ONLY / MINING CLAIM MONEY RECEIVED (455) CASES: AMC336027/\$1750.00	MAINT 2007/14	- n/a -	1750.00
<b>TOTAL:</b>					<b>\$1,750.00</b>

PAYMENT INFORMATION			
NOTE: Items will appear on credit card statement as "Bureau of Land Management".			
1	AMOUNT:	\$1,750.00	POSTMARKED: N/A
	TYPE:	CREDIT CARD	RECEIVED: 08/09/2006
	NAME:	MILLS, THOMAS O 1754 BRAHMA ST PASO ROBLES CA 93446	
	CARD NO:	XXXXXXXXXXXX5806	AUTH CODE: 828550
	NAME ON CARD:	THOMAS O MILLS	
	EXPIRES:	10/31/2007	
	SIGNATURE:		

REMARKS

This receipt was generated by the automated BLM Collections and Billing System and is a paper representation of a portion of the official electronic record contained therein.

FEE
\$5
\$8 ✓
\$5 ✓
\$1
\$14.00

MAIL TO:

THOMAS MILLS  
8435 PASEO DE CABALLO  
ATASCADERO, CA  
93422-5309

3760969 BK 4183 PG 45  
Yavapai County, Arizona  
Patsy Jenney-Colon, Recorder  
09/01/2004 03:05P PAGE 1 OF 1  
THOMAS MILLS  
RECORDING FEE 5.00  
SURCHARGE 8.00  
POSTAGE 1.00

Maintenance Fee Payment

AMC 300253

336027

Bureau Of Land Management  
Arizona State Office  
222 North Central Avenue  
Phoenix, Az. 85004-2203

The Claims are situated in YAVAPAI County, Arizona

BLM SERIAL NUMBERS

NAMES OF CLAIMS

(6) AMC 336027 THRU AMC 336032 SMH (SANTA MARIN Homconce)

COUNTY BOOK/DOCKET \_\_\_\_\_ PAGES OR FEE NOS \_\_\_\_\_

(8) AMC 300253 THRU AMC 300260 SMR (SANTA MARIA RIVER)

COUNTY BOOK/DOCKET \_\_\_\_\_ PAGES OR FEE NOS \_\_\_\_\_

CLAIMANT'S NAME THOMAS O. MILLS

ADDRESS 8435 PASCO DE CABALLO CITY ATASCADERO ST. CALIF.

PHONE 817-313-6422 ZIP 93422

SIGNATURE Thomas O. Mills 8-6-2004

14 Claims  
x 125  
\$1750.00

PHOENIX, ARIZONA

2005 AUG 23 A 9 15

RECEIVED  
B.L.M. AZ STATE OFFICE

2005 AUG 10 A 11 12  
# 1135064

**United States Department of the Interior**  
**Bureau of Land Management**  
 BUSINESS & SUPPORT SVCS DIV  
 222 N CENTRAL AVE  
 PHOENIX, AZ 85004 -2203  
 Phone: (602) 417-9200

Receipt

No: 1135064

**Transaction #:** 1174189  
**Date of Transaction:** 08/23/2005

**CUSTOMER:** THOMAS O MILLS  
 8435 PASEO DE CABALLO  
 ATASCADERO, CA 93422

LINE #	QTY	DESCRIPTION	REMARKS	UNIT PRICE	TOTAL
1	1.00	LOCATABLE MINERALS / MINING CLAIMS-NOT NEW-UNADJUD, ONE AUTH NO. ONLY / MINING CLAIM MONEY RECEIVED (455) CASES: AMC336027/\$1750.00	MAINT 2006/1	- n/a -	1750.00
<b>TOTAL:</b>					<b>\$1,750.00</b>

**PAYMENT INFORMATION**

NOTE: Items will appear on credit card statement as "Bureau of Land Management".

1	<b>AMOUNT:</b>	\$1,750.00	<b>POSTMARKED:</b>	N/A
	<b>TYPE:</b>	CREDIT CARD	<b>RECEIVED:</b>	08/23/2005
	<b>NAME:</b>	MILLS, THOMAS O 8435 PASEO DE CABALLO ATASCADERO CA 93422		
	<b>CARD NO:</b>	XXXXXXXXXXXX5806	<b>AUTH CODE:</b>	871886
	<b>NAME ON CARD:</b>	THOMAS O MILLS		
	<b>EXPIRES:</b>	10/31/2007		
	<b>SIGNATURE:</b>			

**REMARKS**

This receipt was generated by the automated BLM Collections and Billing System and is a paper representation of a portion of the official electronic record contained therein.

Amc 300253

Amc 336027

### Maintenance Fee Payment

Bureau Of Land Management  
Arizona State Office  
222 North Central Avenue  
Phoenix, Az. 85004-2203

The Claims are situated in YAVAPAI County, Arizona

BLM SERIAL NUMBERS

NAMES OF CLAIMS

(6) AMC 336027 THRU AMC 336032 SMH (SANTA MARIA HOMEPLACE)

COUNTY BOOK/DOCKET \_\_\_\_\_ PAGES OR FEE NOS \_\_\_\_\_

(8) AMC 300253 THRU AMC 300260 SMR (SANTA MARIA RIVER)

COUNTY BOOK/DOCKET \_\_\_\_\_ PAGES OR FEE NOS \_\_\_\_\_

CLAIMANT'S NAME THOMAS O. MILLS

ADDRESS 8435 PASCO DE CABALLO CITY ATASCADERO ST. CALIF.

PHONE 817-313-6422 ZIP 93422

SIGNATURE Thomas O. Mills 8-6-2004

ENTERED INTO COMPUTER  
SEP 10 2004 PB

ARIZONA  
STATE OFFICE  
PHOENIX, ARIZONA

2004 AUG 10 A 9:12

RECEIVED  
BUREAU OF  
LAND MANAGEMENT

Thomas O. Mills or  
Gigi Mills  
8435 Paseo De Caballo  
Atascadero, CA 93422-5309

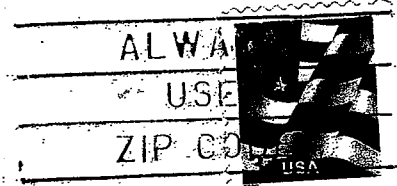

RECEIVED  
BUREAU OF  
LAND MANAGEMENT

2001 AUG 10 A 9:12

ARIZONA  
STATE OFFICE  
PHOENIX, ARIZONA

BLM  
ARIZONA STATE OFFICE  
222 North Central AVE.  
Phoenix, ARIZONA

85004+2203



85004-2203



**United States Department of the Interior**  
**Bureau of Land Management**  
 BUSINESS & SUPPORT SVCS DIV  
 222 N CENTRAL AVE  
 PHOENIX, AZ 85004 -2203  
 Phone: (602) 417-9200

Receipt	
No:	925473

**Transaction #:** 959636  
**Date of Transaction:** 08/10/2004

<b>CUSTOMER:</b>	THOMAS O MILLS 8435 PASEO DE CABALLO ATASCADERO, CA 93422-5309
------------------	--

LINE #	QTY	DESCRIPTION	REMARKS	UNIT PRICE	TOTAL
1	1.00	LOCATABLE MINERALS / MINING CLAIMS-NOT NEW-UNADJUD, ONE AUTH NO. ONLY / MINING CLAIM MONEY RECEIVED (455) CASES: AMC336027/\$1750.00	MAINT 2005 (14)	- n/a -	1750.00
<b>TOTAL:</b>					<b>\$1,750.00</b>

PAYMENT INFORMATION																	
1	<table border="1"> <tr> <td>AMOUNT:</td> <td>\$1,750.00</td> <td>POSTMARKED:</td> <td>08/06/2004</td> </tr> <tr> <td>TYPE:</td> <td>CHECK</td> <td>RECEIVED:</td> <td>08/10/2004</td> </tr> <tr> <td>CHECK NO:</td> <td>3819</td> <td></td> <td></td> </tr> <tr> <td>NAME:</td> <td colspan="3">MILLS, THOMAS O                      8435 PASEO DE CABALLO                      ATASCADERO CA 93422 5309</td> </tr> </table>	AMOUNT:	\$1,750.00	POSTMARKED:	08/06/2004	TYPE:	CHECK	RECEIVED:	08/10/2004	CHECK NO:	3819			NAME:	MILLS, THOMAS O 8435 PASEO DE CABALLO ATASCADERO CA 93422 5309		
AMOUNT:	\$1,750.00	POSTMARKED:	08/06/2004														
TYPE:	CHECK	RECEIVED:	08/10/2004														
CHECK NO:	3819																
NAME:	MILLS, THOMAS O 8435 PASEO DE CABALLO ATASCADERO CA 93422 5309																

REMARKS

This receipt was generated by the automated BLM Collections and Billing System and is a paper representation of a portion of the official electronic record contained therein.

AMC 300253

AMC 336027

### MAINTENANCE FEE PAYMENT

\$100.00 MAINTENANCE FEE PAYMENT DUE ON OR BEFORE SEP 01 2003  
IN LIEU OF ASSESSMENT WORK FOR THE UPCOMING ASSESSMENT  
YEAR BEGINNING SEPTEMBER 1 OF THE YEAR NOTED ABOVE.

Bureau Of Land Management  
Arizona State Office  
222 North Central Avenue  
Phoenix, AZ. 85004-2203

Ck 3542  
COUNT: 14 \$ 1400 INT: 0  
FOR OFFICIAL USE ONLY

THE CLAIMS ARE SITUATED IN Yavapai COUNTY,  
ARIZONA.

BLM SERIAL NUMBERS

NAMES OF CLAIMS OR SITES

A MC 336027 THRU A MC 336032 SMH (SANTA MARIA Homestead)

COUNTY BOOK/DOCKET \_\_\_\_\_, PAGE(S) OR FEE NO(S) \_\_\_\_\_

A MC 300253 THRU A MC 300260 SMR (SANTA MARIA RIVER)

COUNTY BOOK/DOCKET \_\_\_\_\_, PAGE(S) OR FEE NO(S) \_\_\_\_\_

(OR) IF NOT CONSECUTIVE NUMBERS LIST SEPARATELY BELOW:

BLM SERIAL NUMBERS	NAME OF CLAIMS/SITES	COUNTY BOOK/DOCKET & PAGE OR FEE NUMBER
A MC _____	_____	_____
A MC _____	_____	_____
A MC _____	_____	_____
A MC _____	_____	_____
A MC _____	_____	_____
A MC _____	_____	_____
A MC _____	_____	_____
A MC _____	_____	_____
A MC _____	_____	_____
A MC _____	_____	_____

CLAIMANT'S NAME: Thomas O. Mills  
ADDRESS: 8435 PASO De Cobello CITY: ATASCADERO STATE: CA

CHECK HERE IF THIS IS A CHANGE OF ADDRESS

PHONE: (817) 313-6422

ARIZONA BUREAU OF LAND MANAGEMENT PHOENIX, ARIZONA

SIGNATURE: Thomas O. Mills  
TO RECORD WITH THE COUNTY, ONE CLAIMANT OR THE AGENT MUST SIGN

LIST ALL ADDITIONAL OWNERS ON REVERSE SIDE OF THIS FORM

FOR OFFICIAL USE ONLY  
ENTERED INTO COMPUTER: 8/21/03 RE  
DATE INITIALS VERIFIED

RECEIVED BUREAU OF LAND MANAGEMENT  
2003 AUG - 7 10:40 AM  
TIME STAMP

43 CFR 3833.0-5(e) (August 30, 1994) REQUIRES THAT THE NAMES OF ALL OF THE OWNERS AND THEIR CURRENT ADDRESSES SHALL BE IDENTIFIED ON ALL INSTRUMENTS REQUIRED TO BE RECORDED OR FILED BY THE REGULATIONS, 43 CFR SUBPART 3833.

CLAIMANT'S NAME: \_\_\_\_\_

ADDRESS: \_\_\_\_\_ CITY: \_\_\_\_\_ STATE: \_\_\_\_\_

CHECK HERE IF THIS IS CHANGE OF ADDRESS      PHONE: (    )      ZIP: \_\_\_\_\_

CLAIMANT'S NAME: \_\_\_\_\_

ADDRESS: \_\_\_\_\_ CITY: \_\_\_\_\_ STATE: \_\_\_\_\_

CHECK HERE IF THIS IS CHANGE OF ADDRESS      PHONE: (    )      ZIP: \_\_\_\_\_

CLAIMANT'S NAME: \_\_\_\_\_

ADDRESS: \_\_\_\_\_ CITY: \_\_\_\_\_ STATE: \_\_\_\_\_

CHECK HERE IF THIS IS CHANGE OF ADDRESS      PHONE: (    )      ZIP: \_\_\_\_\_

CLAIMANT'S NAME: \_\_\_\_\_

ADDRESS: \_\_\_\_\_ CITY: \_\_\_\_\_ STATE: \_\_\_\_\_

CHECK HERE IF THIS IS CHANGE OF ADDRESS      PHONE: (    )      ZIP: \_\_\_\_\_

CLAIMANT'S NAME: \_\_\_\_\_

ADDRESS: \_\_\_\_\_ CITY: \_\_\_\_\_ STATE: \_\_\_\_\_

CHECK HERE IF THIS IS CHANGE OF ADDRESS      PHONE: (    )      ZIP: \_\_\_\_\_

CLAIMANT'S NAME: \_\_\_\_\_

ADDRESS: \_\_\_\_\_ CITY: \_\_\_\_\_ STATE: \_\_\_\_\_

CHECK HERE IF THIS IS CHANGE OF ADDRESS      PHONE: (    )      ZIP: \_\_\_\_\_

CLAIMANT'S NAME: \_\_\_\_\_

ADDRESS: \_\_\_\_\_ CITY: \_\_\_\_\_ STATE: \_\_\_\_\_

CHECK HERE IF THIS IS CHANGE OF ADDRESS      PHONE: (    )      ZIP: \_\_\_\_\_

**United States Department of the Interior**  
**Bureau of Land Management**  
 BUSINESS & SUPPORT SVCS DIV  
 222 N CENTRAL AVE  
 PHOENIX, AZ 85004 -2203  
 Phone: (602) 417-9200

Receipt  
 No: 726242

**Transaction #:** 755546  
**Date of Transaction:** 08/08/2003

**CUSTOMER:** THOMAS O MILLS  
 8435 PASEO DE CABALLO  
 ATASCADERO, CA 93422

LINE #	QTY	DESCRIPTION	REMARKS	UNIT PRICE	TOTAL
1	1.00	LOCATABLE MINERALS / MINING CLAIMS-NOT NEW-UNADJUD, ONE AUTH NO. ONLY / MINING CLAIM MONEY RECEIVED (455) <b>CASES: AMC336027/\$1400.00</b>	MAINT 2004 (14)	- n/a -	1400.00
<b>TOTAL:</b>					<b>\$1,400.00</b>

PAYMENT INFORMATION					
1	AMOUNT:	\$1,400.00	POSTMARKED:	08/05/2003	
	TYPE:	CHECK	RECEIVED:	08/07/2003	
	CHECK NO:	3542			
	NAME:	MILLS, THOMAS O 8435 PASEO DE CABALLO ATASCADERO CA 93422			

REMARKS

This receipt was generated by the automated BLM Collections and Billing System and is a paper representation of a portion of the official electronic record contained therein.

Receipt No. 540202

LEAD FILE #'S \_\_\_\_\_

Trans No. 564679

300253, 336027

AMC Number	Code	Amount
300253-300260	482	800
336027-336032	482	600
<b>TOTAL:</b>		<b>\$1,400</b>

AMC Number	Code	Amount
<b>TOTAL:</b>		<b>\$</b>

Date of Doc 8/14/02

Date Entered: 9/26/02 AB

Date of Rec't " "

Date Verified: " "

Amount Rec'd 1,400

Sent to Accts: " "

Amount Earned 1,400

Date Earned: \_\_\_\_\_

- 480 POL
- 481 NOI
- 482 MAINT
- 396 TRANS
- 635 AMEND

NOTES:

## MAINTENANCE FEE PAYMENT

**\$100.00 MAINTENANCE FEE PAYMENT DUE ON OR BEFORE SEP 01 02**  
**IN LIEU OF ASSESSMENT WORK FOR THE UPCOMING ASSESSMENT**  
**YEAR BEGINNING SEPTEMBER 1 OF THE YEAR NOTED ABOVE.**

Bureau Of Land Management  
 Arizona State Office  
 222 North Central Avenue  
 Phoenix, AZ. 85004-2203

COUNT: 14 \$ 1400 INT: LH  
 FOR OFFICIAL USE ONLY

THE CLAIMS ARE SITUATED IN Yavapai COUNTY, ARIZONA.

BLM SERIAL NUMBERS

NAMES OF CLAIMS OR SITES

A MC 336027 THRU A MC 336032 S.M.H. thru 6

COUNTY BOOK/DOCKET \_\_\_\_\_, PAGE(S) OR FEE NO(S) \_\_\_\_\_

A MC 300253 THRU A MC 300260 S.M.R. thru 8

COUNTY BOOK/DOCKET \_\_\_\_\_, PAGE(S) OR FEE NO(S) \_\_\_\_\_

(OR) IF NOT CONSECUTIVE NUMBERS LIST SEPARATELY BELOW:

BLM SERIAL NUMBERS	NAME OF CLAIMS/SITES	COUNTY BOOK/DOCKET & PAGE OR FEE NUMBER
A MC _____	_____	_____
A MC _____	_____	_____
A MC _____	_____	_____
A MC _____	_____	_____
A MC _____	_____	_____
A MC _____	_____	_____
A MC _____	_____	_____
A MC _____	_____	_____
A MC _____	_____	_____
A MC _____	_____	_____

CLAIMANT'S NAME: THOMAS O. Mills

ADDRESS: 26402 S. Flame Tree Dr. CITY: Sun Lakes STATE: AZ  
Flame Tree Dr. San Lakes

CHECK HERE IF THIS IS A CHANGE OF ADDRESS PHONE: (817) 313-6422 ZIP: 85248

SIGNATURE: Thomas O. Mills  
 TO RECORD WITH THE COUNTY, ONE CLAIMANT OR THE AGENT MUST SIGN

LIST ALL ADDITIONAL OWNERS ON REVERSE SIDE OF THIS FORM

FOR OFFICIAL USE ONLY

ENTERED INTO COMPUTER: 9/26/02 AB  
DATE INITIALS VERIFIED

RECEIVED  
 BLM AZ STATE OFFICE  
 PHOENIX, ARIZONA  
 AUG 14 A 9:51

**United States Department of the Interior**  
**Bureau of Land Management**  
 BUSINESS & SUPPORT SVCS DIV  
 222 N CENTRAL AVE  
 PHOENIX, AZ 85004 -2203  
 Phone: (602) 417-9200

Receipt	
No:	540202

<b>Transaction #:</b> 564679
<b>Date of Transaction:</b> 08/14/2002
<b>CUSTOMER:</b> THOMAS O MILLS 26402 S FLAME TREE DR SUN LAKES, AZ 85248

LINE #	QTY	DESCRIPTION	REMARKS	UNIT PRICE	TOTAL
1	1.00	LOCATABLE MINERALS / MINING CLAIMS-NOT NEW-UNADJUD, ONE AUTH NO. ONLY / MINING CLAIM MONEY RECEIVED (455) <b>CASES:</b> AMC336027/\$1400.00	MAINT 2003 (14)	- n/a -	1400.00
<b>TOTAL:</b>					<b>\$1,400.00</b>

PAYMENT INFORMATION			
NOTE: Items will appear on credit card statement as "Bureau of Land Management".			
1	AMOUNT:	\$1,400.00	POSTMARKED: N/A
	TYPE:	CREDIT CARD	RECEIVED: 08/14/2002
	NAME:	MILLS, THOMAS O 26402 S FLAME TREE DR SUN LAKES AZ 85248	
	CARD NO:	XXXXXXXXXXXX8847	AUTH CODE: 953082
	NAME ON CARD:	THOMAS O MILLS	
	EXPIRES:	10/31/2004	
	SIGNATURE:		

REMARKS

This receipt was generated by the automated BLM Collections and Billing System and is a paper representation of a portion of the official electronic record contained therein.





**MAINTENANCE FEE PAYMENT** *Sept. 01, 2002*

\$100.00 MAINTENANCE FEE PAYMENT DUE ON OR BEFORE AUGUST 31, 19\_\_\_\_  
 IN LIEU OF ASSESSMENT WORK FOR THE UPCOMING ASSESSMENT  
 YEAR BEGINNING SEPTEMBER 1 OF THE YEAR NOTED ABOVE.

BUREAU OF LAND MANAGEMENT  
 ARIZONA STATE OFFICE  
 222 NORTH CENTRAL AVENUE  
 PHOENIX, AZ 85004-2003

COUNT: 14 \$ 1400.<sup>00</sup> INT: KC  
 FOR OFFICIAL USE ONLY

THE CLAIMS ARE SITUATED IN \_\_\_\_\_ COUNTY, ARIZONA.

BLM SERIAL NUMBERS NAMES OF CLAIMS OR SITES

A MC 336027 THRU A MC 336032 SMH  
 COUNTY BOOK/DOCKET \_\_\_\_\_, PAGE(S) OR FEE NO(S) \_\_\_\_\_

A MC 300253 THRU A MC 300260 SMR  
 COUNTY BOOK/DOCKET \_\_\_\_\_, PAGE(S) OR FEE NO(S) \_\_\_\_\_

(OR) IF NOT CONSECUTIVE NUMBERS LIST SEPARATELY BELOW:

BLM SERIAL NUMBERS	NAME OF CLAIMS/SITES	COUNTY BOOK/DOCKET & PAGE OR FEE NUMBER
A MC _____	_____	_____
A MC _____	_____	_____
A MC _____	_____	_____
A MC _____	_____	_____
A MC _____	_____	_____
A MC _____	_____	_____
A MC _____	_____	_____
A MC _____	_____	_____
A MC _____	_____	_____
A MC _____	_____	_____
A MC _____	_____	_____
A MC _____	_____	_____
A MC _____	_____	_____
A MC _____	_____	_____
A MC _____	_____	_____

CLAIMANT'S NAME: THOMAS O. Mills

ADDRESS: 26402 S. Flame Tree DR CITY: SUN LAKE STATE: AZ

CHECK HERE IF THIS IS A CHANGE OF ADDRESS PHONE: (817) 313-6422 ZIP: 85248

SIGNATURE: Thomas O. Mills  
 TO RECORD WITH THE COUNTY, ONE CLAIMANT OR THE AGENT MUST SIGN.

LIST ALL ADDITIONAL OWNERS ON REVERSE SIDE OF THIS FORM

FOR OFFICIAL USE ONLY

ENTERED INTO COMPUTER: \_\_\_\_\_  
DATE INITIALS VERIFIED

RECEIVED  
 BLM STATE OFFICE  
 TIME STAMP  
 2002 AUG 14 10:00

43 CFR 3833.0-5(e) (August 30, 1994) REQUIRES THAT THE NAMES OF ALL OF THE OWNERS AND THEIR CURRENT ADDRESSES SHALL BE IDENTIFIED ON ALL INSTRUMENTS REQUIRED TO BE RECORDED OR FILED BY THE REGULATIONS, 43 CFR SUBPART 3833.

CLAIMANT'S NAME: \_\_\_\_\_  
ADDRESS: \_\_\_\_\_ CITY: \_\_\_\_\_ STATE: \_\_\_\_\_  
 CHECK HERE IF THIS PHONE: ( ) ZIP: \_\_\_\_\_ IS  
CHANGE OF ADDRESS

CLAIMANT'S NAME: \_\_\_\_\_  
ADDRESS: \_\_\_\_\_ CITY: \_\_\_\_\_ STATE: \_\_\_\_\_  
 CHECK HERE IF THIS PHONE: ( ) ZIP: \_\_\_\_\_ IS  
CHANGE OF ADDRESS

CLAIMANT'S NAME: \_\_\_\_\_  
ADDRESS: \_\_\_\_\_ CITY: \_\_\_\_\_ STATE: \_\_\_\_\_  
 CHECK HERE IF THIS PHONE: ( ) ZIP: \_\_\_\_\_ IS  
CHANGE OF ADDRESS

CLAIMANT'S NAME: \_\_\_\_\_  
ADDRESS: \_\_\_\_\_ CITY: \_\_\_\_\_ STATE: \_\_\_\_\_  
 CHECK HERE IF THIS PHONE: ( ) ZIP: \_\_\_\_\_ IS  
CHANGE OF ADDRESS

CLAIMANT'S NAME: \_\_\_\_\_  
ADDRESS: \_\_\_\_\_ CITY: \_\_\_\_\_ STATE: \_\_\_\_\_  
 CHECK HERE IF THIS PHONE: ( ) ZIP: \_\_\_\_\_ IS  
CHANGE OF ADDRESS

CLAIMANT'S NAME: \_\_\_\_\_  
ADDRESS: \_\_\_\_\_ CITY: \_\_\_\_\_ STATE: \_\_\_\_\_  
 CHECK HERE IF THIS PHONE: ( ) ZIP: \_\_\_\_\_ IS  
CHANGE OF ADDRESS

CLAIMANT'S NAME: \_\_\_\_\_  
ADDRESS: \_\_\_\_\_ CITY: \_\_\_\_\_ STATE: \_\_\_\_\_  
 CHECK HERE IF THIS PHONE: ( ) ZIP: \_\_\_\_\_ IS  
CHANGE OF ADDRESS

CLAIMANT'S NAME: \_\_\_\_\_  
ADDRESS: \_\_\_\_\_ CITY: \_\_\_\_\_ STATE: \_\_\_\_\_  
 CHECK HERE IF THIS PHONE: ( ) ZIP: \_\_\_\_\_ IS  
CHANGE OF ADDRESS

**United States Department of the Interior**  
**Bureau of Land Management**  
 BUSINESS & SUPPORT SVCS DIV  
 222 N CENTRAL AVE  
 PHOENIX, AZ 85004 -2203  
 Phone: (602) 417-9200

Receipt	
No:	355935

**Transaction #:** 374224  
**Date of Transaction:** 08/14/2001

**CUSTOMER:** THOMAS O MILLS  
 26402 S. FLAME TREE DR.  
 SUN LAKES, AZ 85248

LINE #	QTY	COMMODITY / SUBJECT / ACTION / PRODUCT	REMARKS	UNIT PRICE	TOTAL
1	1.00	LOCATABLE MINERALS / MINING CLAIMS-NOT NEW-UNADJUD, ONE AUTH NO. ONLY / MINING CLAIM MONEY RECEIVED (455)	MAINT FEES 2002 (14)	- n/a -	\$1,400.00
<b>TOTAL:</b>					<b>\$1,400.00</b>

PAYMENT INFORMATION			
1	AMOUNT:	\$1,400.00	POSTMARKED: N/A
	TYPE:	CHECK	RECEIVED: 08/14/2001
	CHECK NO:	446	
	NAME:	MILLS, THOMAS O 26402 S. FLAME TREE DR. SUN LAKES AZ 85248	

REMARKS

CASE SERIAL NUMBER INFORMATION		
TRNS #	LINE #	CASES
374224	1	AMC300253/\$1400.00

This receipt was generated by the automated BLM Collections and Billings System and is a paper representation of a portion of the official electronic record contained therein.

Receipt #: 170540

Lead #: 300253 - 336027

Amount Received: 1400.00

Date: 8-17-00

Transaction #: 183692

AMC#	Code	\$\$\$\$\$
300253-300260	482	800.-
336027-336032		600.00

AMC#	Code	\$\$\$\$\$

Total: 1400.

- 480---POL-----\$5
- 481---NOI-----\$5
- 482---Maint.---\$100
- 396---Trf.-----\$5
- 635---Amd.-----\$5
- 379---Refund

Entered: [Signature] 8-17-00  
Date

Verified: [Signature] AUG 22 2000  
Date

Sent to Accounts: AUG 23 2000  
Date

Earned by Accounts: \_\_\_\_\_  
Date

RECEIVED  
BUREAU OF  
LAND MANAGEMENT  
AUG 17 11 05 AM '00  
ARIZONA  
STATE OFFICE  
PHOENIX, ARIZONA

**MAINTENANCE FEE PAYMENT**

**\$100.00 MAINTENANCE FEE PAYMENT DUE ON OR BEFORE SEP 01 2000  
IN LIEU OF ASSESSMENT WORK FOR THE UPCOMING ASSESSMENT  
YEAR BEGINNING SEPTEMBER 1 OF THE YEAR NOTED ABOVE.**

Bureau Of Land Management  
Arizona State Office  
222 North Central Avenue  
Phoenix, AZ. 85004-2203

COUNT: 14 \$ 1400<sup>00</sup> INT: C  
FOR OFFICIAL USE ONLY

THE CLAIMS ARE SITUATED IN Yavapai COUNTY, ARIZONA.

BLM SERIAL NUMBERS	NAMES OF CLAIMS OR SITES
A MC <u>300253</u> THRU A MC <u>300260</u>	<u>SMR - 1-8</u> - 8
COUNTY BOOK/DOCKET _____, PAGE(S) OR FEE NO(S) _____	
A MC <u>336027</u> THRU A MC <u>336032</u>	<u>SMH 1-6-6</u>
COUNTY BOOK/DOCKET _____, PAGE(S) OR FEE NO(S) _____	

(OR) IF NOT CONSECUTIVE NUMBERS LIST SEPARATELY BELOW:

BLM SERIAL NUMBERS	NAME OF CLAIMS/SITES	COUNTY BOOK/DOCKET & PAGE OR FEE NUMBER
A MC _____	_____	_____
A MC _____	_____	_____

**To Whom It May Concern**

Our new address is: **Thomas O. Mills & Glenda (GiGi) Mills**  
**P. O. Box 428**  
**Keller, Texas 76244**  
**817-313-6422**

A MC \_\_\_\_\_  
 A MC \_\_\_\_\_  
 A MC \_\_\_\_\_

CLAIMANT'S NAME: THOMAS O. Mills

ADDRESS: 8800 Davis Blvd CITY: Keller STATE: TX  
P.O. Box 428 OK

CHECK HERE IF THIS IS A CHANGE OF ADDRESS PHONE: (817) 313-6422 ZIP: 76244

SIGNATURE: Thomas O. Mills  
 TO RECORD WITH THE COUNTY, ONE CLAIMANT OR THE AGENT MUST SIGN

LIST ALL ADDITIONAL OWNERS ON REVERSE SIDE OF THIS FORM

FOR OFFICIAL USE ONLY  
 ENTERED INTO COMPUTER: 8-17-00 Jr AUG 22 2000  
 DATE INITIALS VERIFIED

TIME STAMP

43 CFR 3833.0-5(e) (August 30, 1994) REQUIRES THAT THE NAMES OF ALL OF THE OWNERS AND THEIR CURRENT ADDRESSES SHALL BE IDENTIFIED ON ALL INSTRUMENTS REQUIRED TO BE RECORDED OR FILED BY THE REGULATIONS, 43 CFR SUBPART 3833.

CLAIMANT'S NAME: \_\_\_\_\_

ADDRESS: \_\_\_\_\_ CITY: \_\_\_\_\_ STATE: \_\_\_\_\_

CHECK HERE IF THIS IS CHANGE OF ADDRESS      PHONE: (      )      ZIP: \_\_\_\_\_

CLAIMANT'S NAME: \_\_\_\_\_

ADDRESS: \_\_\_\_\_ CITY: \_\_\_\_\_ STATE: \_\_\_\_\_

CHECK HERE IF THIS IS CHANGE OF ADDRESS      PHONE: (      )      ZIP: \_\_\_\_\_

CLAIMANT'S NAME: \_\_\_\_\_

ADDRESS: \_\_\_\_\_ CITY: \_\_\_\_\_ STATE: \_\_\_\_\_

CHECK HERE IF THIS IS CHANGE OF ADDRESS      PHONE: (      )      ZIP: \_\_\_\_\_

CLAIMANT'S NAME: \_\_\_\_\_

ADDRESS: \_\_\_\_\_ CITY: \_\_\_\_\_ STATE: \_\_\_\_\_

CHECK HERE IF THIS IS CHANGE OF ADDRESS      PHONE: (      )      ZIP: \_\_\_\_\_

CLAIMANT'S NAME: \_\_\_\_\_

ADDRESS: \_\_\_\_\_ CITY: \_\_\_\_\_ STATE: \_\_\_\_\_

CHECK HERE IF THIS IS CHANGE OF ADDRESS      PHONE: (      )      ZIP: \_\_\_\_\_

CLAIMANT'S NAME: \_\_\_\_\_

ADDRESS: \_\_\_\_\_ CITY: \_\_\_\_\_ STATE: \_\_\_\_\_

CHECK HERE IF THIS IS CHANGE OF ADDRESS      PHONE: (      )      ZIP: \_\_\_\_\_

CLAIMANT'S NAME: \_\_\_\_\_

ADDRESS: \_\_\_\_\_ CITY: \_\_\_\_\_ STATE: \_\_\_\_\_

CHECK HERE IF THIS IS CHANGE OF ADDRESS      PHONE: (      )      ZIP: \_\_\_\_\_

**United States Department of the Interior  
Bureau of Land Management**  
BUSINESS & SUPPORT SVCS DIV  
222 N CENTRAL AVE  
PHOENIX, AZ 85004 -2203  
Phone: (602) 417-9200

Receipt	
No:	170540

<b>Transaction #:</b> 183692					
<b>Date of Transaction:</b> 08/17/2000					
<b>CUSTOMER:</b>		THOMAS MILLS PO BOX 428 KELLER, TX 76244			
LINE #	QTY	COMMODITY / SUBJECT / ACTION / PRODUCT	REMARKS	UNIT PRICE	TOTAL
1	1	LOCATABLE MINERALS / MINING CLAIMS-ACCOUNTS/UNADJUDICATED / MINING CLAIM MONEY RECEIVED (455)	MAINT 2001 (14)	- n/a -	\$1,400.00
<b>TOTAL:</b>					<b>\$1,400.00</b>

PAYMENT INFORMATION			
1	AMOUNT:	\$1,400.00	POSTMARKED: 08/15/2000
	TYPE:	CHECK	RECEIVED: 08/17/2000
	CHECK NO:	1994	
	NAME:	MILLS, THOMAS O PO BOX 428 KELLER TX 76244	

REMARKS

CASE SERIAL NUMBER INFORMATION		
TRNS #	LINE #	CASES
183692	1	AMC300253

This receipt was generated by the automated BLM Collections and Billings System and is a paper representation of a portion of the official electronic record contained therein.

## MAINTENANCE FEE PAYMENT

**\$100.00 MAINTENANCE FEE PAYMENT DUE ON OR BEFORE AUGUST 31, 1998**  
**IN LIEU OF ASSESSMENT WORK FOR THE UPCOMING ASSESSMENT**  
**YEAR BEGINNING SEPTEMBER 1 OF THE YEAR NOTED ABOVE.**

Bureau Of Land Management  
 Arizona State Office  
 222 North Central Avenue  
 Phoenix, AZ. 85004-2203

COUNT: 14 \$ 1400 INT: TES  
 FOR OFFICIAL USE ONLY

THE CLAIMS ARE SITUATED IN \_\_\_\_\_ COUNTY,  
 ARIZONA.

BLM SERIAL NUMBERS	NAMES OF CLAIMS OR SITES
A MC <u>300253</u> THRU A MC <u>300260</u>	<u>SMR 1-8</u>
COUNTY BOOK/DOCKET _____, PAGE(S) OR FEE NO(S) _____	
A MC <u>261039</u> THRU A MC <u>261044</u>	<u>SMH 1-6</u>
COUNTY BOOK/DOCKET _____, PAGE(S) OR FEE NO(S) _____	

(OR) IF NOT CONSECUTIVE NUMBERS LIST SEPARATELY BELOW:

BLM SERIAL NUMBERS	NAME OF CLAIMS/SITES	COUNTY BOOK/DOCKET & PAGE OR FEE NUMBER
A MC <del>200000</del>	_____	_____
A MC _____	_____	_____
A MC _____	_____	_____
A MC _____	_____	_____
A MC _____	_____	_____
A MC _____	_____	_____
A MC _____	_____	_____
A MC _____	_____	_____
A MC _____	_____	_____
A MC _____	_____	_____

CLAIMANT'S NAME: Thomas O. Mills  
 ADDRESS: 1202 San Augustine CITY: Southlake STATE: TX

CHECK HERE IF THIS IS A CHANGE OF ADDRESS      PHONE: (817) 421-1994      ZIP: 76092

SIGNATURE: Phone payment  
 TO RECORD WITH THE COUNTY, ONE CLAIMANT OR THE AGENT MUST SIGN

LIST ALL ADDITIONAL OWNERS ON REVERSE SIDE OF THIS FORM

FOR OFFICIAL USE ONLY

ENTERED INTO COMPUTER: \_\_\_\_\_ DATE \_\_\_\_\_ INITIALS \_\_\_\_\_ VERIFIED \_\_\_\_\_

TIME STAMP

PHOENIX, ARIZONA

1998 AUG 12 A 9:10

RECEIVED  
 B.L.M. AZ STATE OFFICE



43 CFR 3833.0-5(e) (August 30, 1994) REQUIRES THAT THE NAMES OF ALL OF THE OWNERS AND THEIR CURRENT ADDRESSES SHALL BE IDENTIFIED ON ALL INSTRUMENTS REQUIRED TO BE RECORDED OR FILED BY THE REGULATIONS, 43 CFR SUBPART 3833.

CLAIMANT'S NAME: \_\_\_\_\_

ADDRESS: \_\_\_\_\_ CITY: \_\_\_\_\_ STATE: \_\_\_\_\_

CHECK HERE IF THIS IS CHANGE OF ADDRESS PHONE: (\_\_\_\_) \_\_\_\_\_ ZIP: \_\_\_\_\_

CLAIMANT'S NAME: \_\_\_\_\_

ADDRESS: \_\_\_\_\_ CITY: \_\_\_\_\_ STATE: \_\_\_\_\_

CHECK HERE IF THIS IS CHANGE OF ADDRESS PHONE: (\_\_\_\_) \_\_\_\_\_ ZIP: \_\_\_\_\_

CLAIMANT'S NAME: \_\_\_\_\_

ADDRESS: \_\_\_\_\_ CITY: \_\_\_\_\_ STATE: \_\_\_\_\_

CHECK HERE IF THIS IS CHANGE OF ADDRESS PHONE: (\_\_\_\_) \_\_\_\_\_ ZIP: \_\_\_\_\_

CLAIMANT'S NAME: \_\_\_\_\_

ADDRESS: \_\_\_\_\_ CITY: \_\_\_\_\_ STATE: \_\_\_\_\_

CHECK HERE IF THIS IS CHANGE OF ADDRESS PHONE: (\_\_\_\_) \_\_\_\_\_ ZIP: \_\_\_\_\_

CLAIMANT'S NAME: \_\_\_\_\_

ADDRESS: \_\_\_\_\_ CITY: \_\_\_\_\_ STATE: \_\_\_\_\_

CHECK HERE IF THIS IS CHANGE OF ADDRESS PHONE: (\_\_\_\_) \_\_\_\_\_ ZIP: \_\_\_\_\_

CLAIMANT'S NAME: \_\_\_\_\_

ADDRESS: \_\_\_\_\_ CITY: \_\_\_\_\_ STATE: \_\_\_\_\_

CHECK HERE IF THIS IS CHANGE OF ADDRESS PHONE: (\_\_\_\_) \_\_\_\_\_ ZIP: \_\_\_\_\_

CLAIMANT'S NAME: \_\_\_\_\_

ADDRESS: \_\_\_\_\_ CITY: \_\_\_\_\_ STATE: \_\_\_\_\_

CHECK HERE IF THIS IS CHANGE OF ADDRESS PHONE: (\_\_\_\_) \_\_\_\_\_ ZIP: \_\_\_\_\_

Telephone Conversation Record

A MC 261039  
A MC 336027

December 15, 1998

Caller: Thomas Mills

Telephone Number: (817) 317-1257

Subject: 1999 Maintenance Fee Payments

On December 11, 1998, I sent a letter to Mr. Mills advising that the payment he made on August 12, 1998 identified claims that had been closed.

Mr. Mills telephoned to state that he had inadvertently provided old A MC numbers. He requested that the payment be applied to A MC 336027 through A MC 336032, the correct numbers of his current claims.

I reviewed A MC 336027 through A MC 336032 and noted that Mr. Donald A Blackburn was listed as the owner of record. Upon further review of the case file, I noticed that Tomas Mills was listed as locator, and Mr. Blackburn as agent. It appears that our clerk had made an error, and the records are being corrected today.

Mr. Mills stated that Mr. Blackburn was his agent and that his name had been misspelled, it should be Thomas.

Mr. Mills will be sending this information via FAX, and will follow up with a hard copy.

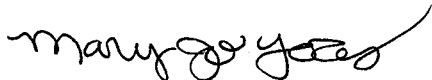

Mary Jo Yoas  
Supervisor, Lands and Minerals Operations

See attached  
Receipt & adv  
advise  
mg 12/15/98

UNITED STATES  
DEPARTMENT OF THE INTERIOR  
BUREAU OF LAND MANAGEMENT

RECEIPT AND ACCOUNTING ADVICE

NO. **2389296** 04

LM/AZ

08/12/98

Subject: CLAIM MAINTENANCE FEE 1999

3 7 42

1,400.00

Applicant:

THOMAS O MILLS  
1202 SAN AUGUSTINE  
SOUTHLAKE TX 76092

*Mr. Mills telephoned  
and requested that  
correct S/N's be input on 12/15/98*

SAME

Remitter: CC

(817) 421-1994

Assignor:

LEASE MANAGEMENT DATA  NEW  UPDATE  PAYMENT

ORIGINAL SERIAL NO.	ASG.	TYPE	ST.	CTY.	FUND SYMBOL	ACRES/UNITS	RATE
AMC 300253, ET AL Amc 336027 et al							

AMOUNT	ANV. DATE	EXP. DATE	BILL CYC.	S/C	DISTRICT	NEXT BILL	MISC. DATA	U of M	ACTUAL UNITS

ASSIGNMENT SERIAL NO.	ASG.	TYPE	ST.	CTY.	FUND SYMBOL	ACRES/UNITS	RATE

AMOUNT	ANV. DATE	EXP. DATE	BILL CYC.	S/C	DISTRICT	NEXT BILL	MISC. DATA	U of M	ACTUAL UNITS

APPLY REMITTANCE

ACTION	FUND SYMBOL	CTY.	AMOUNT
FILING FEE			
RENTAL			
UNEARNED			
REFUND			
TOTAL			600.00
AMOUNT DUE			600.00

Remarks:

*Amc 261039-261044  
Closed by dissem  
dated 5-25-95  
cc refund authorized*

BY:

DATE:

12-70

- Lease in Escrow?
- KGS?
- Auto Escalates?
- Auto Renew?

- Of Interest?
- Operating Rights?
- Operator
- Bond Filed?

FOR MMS USE ONLY

BILLEE NUMBER	FOREST REFUGE
OCS SECTION CODE	

AMC  
336027  
R43

### MAINTENANCE FEE PAYMENT

\$100.00 MAINTENANCE FEE PAYMENT DUE ON OR BEFORE AUGUST 31, 19 97  
IN LIEU OF ASSESSMENT WORK FOR THE UPCOMING ASSESSMENT  
YEAR BEGINNING SEPTEMBER 1 OF THE YEAR NOTED ABOVE.

BUREAU OF LAND MANAGEMENT  
ARIZONA STATE OFFICE  
222 NORTH CENTRAL AVENUE  
PHOENIX, AZ 85004-2003

COUNT: 6 \$ 600.00 INT: ERS  
FOR OFFICIAL USE ONLY

THE CLAIMS ARE SITUATED IN \_\_\_\_\_ COUNTY, ARIZONA.

BLM SERIAL NUMBERS NAMES OF CLAIMS OR SITES  
A MC 336027 THRU A MC 336032 SMH #1 thru #6  
COUNTY BOOK/DOCKET \_\_\_\_\_, PAGE(S) OR FEE NO(S) \_\_\_\_\_  
A MC \_\_\_\_\_ THRU A MC \_\_\_\_\_  
COUNTY BOOK/DOCKET \_\_\_\_\_, PAGE(S) OR FEE NO(S) \_\_\_\_\_

(OR) IF NOT CONSECUTIVE NUMBERS LIST SEPARATELY BELOW:

BLM SERIAL NUMBERS	NAME OF CLAIMS/SITES	COUNTY BOOK/DOCKET & PAGE OR FEE NUMBER
A MC _____	_____	_____
A MC _____	_____	_____
A MC _____	_____	_____
A MC _____	_____	_____
A MC _____	_____	_____
A MC _____	_____	_____
A MC _____	_____	_____
A MC _____	_____	_____
A MC _____	_____	_____
A MC _____	_____	_____
A MC _____	_____	_____
A MC _____	_____	_____
A MC _____	_____	_____
A MC _____	_____	_____
A MC _____	_____	_____

CLAIMANT'S NAME: Tom Mills  
ADDRESS: 1202 SAN Augustine CITY: Southlake STATE: TX  
 CHECK HERE IF THIS IS A CHANGE OF ADDRESS PHONE: (817) 317-1257 ZIP: 76092

SIGNATURE: Phone in  
TO RECORD WITH THE COUNTY, ONE CLAIMANT OR THE AGENT MUST SIGN

LIST ALL ADDITIONAL OWNERS ON REVERSE SIDE OF THIS FORM

FOR OFFICIAL USE ONLY  
ENTERED INTO COMPUTER: 9/9/97 ERS [Signature]  
DATE INITIALS VERIFIED

TIME STAMP  
PHOENIX, ARIZONA  
Aug 13 10 59 AM '97  
RECEIVED  
BLM AZ STATE OFFICE

43 CFR 3833.0-5(e) (August 30, 1994) REQUIRES THAT THE NAMES OF ALL OF THE OWNERS AND THEIR CURRENT ADDRESSES SHALL BE IDENTIFIED ON ALL INSTRUMENTS REQUIRED TO BE RECORDED OR FILED BY THE REGULATIONS, 43 CFR SUBPART 3833.

CLAIMANT'S NAME: \_\_\_\_\_  
ADDRESS: \_\_\_\_\_ CITY: \_\_\_\_\_ STATE: \_\_\_\_\_  
 CHECK HERE IF THIS PHONE: ( ) ZIP: \_\_\_\_\_ IS  
CHANGE OF ADDRESS

CLAIMANT'S NAME: \_\_\_\_\_  
ADDRESS: \_\_\_\_\_ CITY: \_\_\_\_\_ STATE: \_\_\_\_\_  
 CHECK HERE IF THIS PHONE: ( ) ZIP: \_\_\_\_\_ IS  
CHANGE OF ADDRESS

CLAIMANT'S NAME: \_\_\_\_\_  
ADDRESS: \_\_\_\_\_ CITY: \_\_\_\_\_ STATE: \_\_\_\_\_  
 CHECK HERE IF THIS PHONE: ( ) ZIP: \_\_\_\_\_ IS  
CHANGE OF ADDRESS

CLAIMANT'S NAME: \_\_\_\_\_  
ADDRESS: \_\_\_\_\_ CITY: \_\_\_\_\_ STATE: \_\_\_\_\_  
 CHECK HERE IF THIS PHONE: ( ) ZIP: \_\_\_\_\_ IS  
CHANGE OF ADDRESS

CLAIMANT'S NAME: \_\_\_\_\_  
ADDRESS: \_\_\_\_\_ CITY: \_\_\_\_\_ STATE: \_\_\_\_\_  
 CHECK HERE IF THIS PHONE: ( ) ZIP: \_\_\_\_\_ IS  
CHANGE OF ADDRESS

CLAIMANT'S NAME: \_\_\_\_\_  
ADDRESS: \_\_\_\_\_ CITY: \_\_\_\_\_ STATE: \_\_\_\_\_  
 CHECK HERE IF THIS PHONE: ( ) ZIP: \_\_\_\_\_ IS  
CHANGE OF ADDRESS

CLAIMANT'S NAME: \_\_\_\_\_  
ADDRESS: \_\_\_\_\_ CITY: \_\_\_\_\_ STATE: \_\_\_\_\_  
 CHECK HERE IF THIS PHONE: ( ) ZIP: \_\_\_\_\_ IS  
CHANGE OF ADDRESS

CLAIMANT'S NAME: \_\_\_\_\_  
ADDRESS: \_\_\_\_\_ CITY: \_\_\_\_\_ STATE: \_\_\_\_\_  
 CHECK HERE IF THIS PHONE: ( ) ZIP: \_\_\_\_\_ IS  
CHANGE OF ADDRESS

UNITED STATES  
DEPARTMENT OF THE INTERIOR  
BUREAU OF LAND MANAGEMENT

RECEIPT AND ACCOUNTING ADVICE

NO. 2315282 04

TC/AZ

08/13/97

Subject: CLAIM MAINTENANCE FEE 1998 - 6

3 1 53

600.00

Applicant:  
TOM MILLS  
1202 SAN AGUSTINE COURT  
SOUTH LAKE TX 76092

Remitter: CC  
817-317-1257

Assignor:

LEASE MANAGEMENT DATA									
<input type="checkbox"/> NEW <input type="checkbox"/> UPDATE <input type="checkbox"/> PAYMENT									
ORIGINAL SERIAL NO.	ASG.	TYPE	ST.	CTY.	FUND SYMBOL			ACRES/UNITS	RATE
AMC 336027 - 336032									
<del>XXXXXXXXXXXXXXXXXXXX</del>									
AMOUNT	ANV. DATE	EXP. DATE	BILL CYC.	S/C	DISTRICT	NEXT BILL	MISC. DATA	U of M	ACTUAL UNITS
ASSIGNMENT SERIAL NO.	ASG.	TYPE	ST.	CTY.	FUND SYMBOL			ACRES/UNITS	RATE
AMOUNT	ANV. DATE	EXP. DATE	BILL CYC.	S/C	DISTRICT	NEXT BILL	MISC. DATA	U of M	ACTUAL UNITS

APPLY REMITTANCE			
ACTION	FUND SYMBOL	CTY.	AMOUNT
FILING FEE			
RENTAL			
UNEARNED			
REFUND			
TOTAL			
AMOUNT DUE			

Remarks:

BY: \_\_\_\_\_ DATE: \_\_\_\_\_

- Lease in Escrow?
- KGS?                      Of Interest?
- Auto Escalates?            Operating Rights?
- Auto Renew?                Operator
- Bond Filed?

FOR MMS USE ONLY		
BILLEE	NUMBER	FOREST REFUGE
OCS SECTION		
CODE		

OFFICIAL COPIES /CF/ /SD READ/ /GROUP/ /SECTION/ /AUTHOR/

*MJY 12/24/96*

3800 (952.3) MH  
A MC 336027

DEC 26 1996

Mr. Tom Mills  
P.O. Box 20238  
Wickenburg, Arizona 85358

Dear Mr. Mills:

According to the official Bureau of Land Management records, the claims listed below were closed by a Decision dated 12/14/95 (copy enclosed):

<u>BLM SERIAL NUMBER</u>	<u>CLAIM NAME</u>
AMC 336033	SMH #7
AMC 336034	SMH #8

Because the claims are closed and are therefore inactive, the maintenance payment may not be credited. A refund of the \$200 maintenance fee submitted has been authorized. You should receive a check in approximately four to six weeks.

If additional information is required, please contact Mary Hyde at (602) 417-9356.

Sincerely,



Mary Jo Yoas  
Chief, Lands and Minerals Adjudication

Enclosure

MHYDE:ers:12/19/96:336027

336027  
300253  
339240 MH

### MAINTENANCE FEE PAYMENT

\$100.00 MAINTENANCE FEE PAYMENT DUE ON OR BEFORE AUGUST 31, 1996  
IN LIEU OF ASSESSMENT WORK FOR THE UPCOMING ASSESSMENT  
YEAR BEGINNING SEPTEMBER 1 OF THE YEAR NOTED ABOVE.

BUREAU OF LAND MANAGEMENT  
ARIZONA STATE OFFICE  
3707 NORTH 7TH STREET  
PHOENIX, AZ 85014 (OR)  
P.O. BOX 16563, PHOENIX, AZ 85011

336027  
COUNT: 8 \$ 800.<sup>00</sup> INT: KC  
FOR OFFICIAL USE ONLY

THE CLAIMS ARE SITUATED IN Yavapai COUNTY,  
ARIZONA.

BLM SERIAL NUMBERS

NAMES OF CLAIMS OR SITES

\* A MC 336027 THRU A MC 336034 SMH 1 thru 8 #

COUNTY BOOK/DOCKET \_\_\_\_\_, PAGE(S) OR FEE NO(S) \_\_\_\_\_

A MC \_\_\_\_\_ THRU A MC \_\_\_\_\_

COUNTY BOOK/DOCKET \_\_\_\_\_, PAGE(S) OR FEE NO(S) \_\_\_\_\_

(OR) IF NOT CONSECUTIVE NUMBERS LIST SEPARATELY BELOW:

BLM SERIAL NUMBERS	NAME OF CLAIMS/SITES	COUNTY BOOK/DOCKET & PAGE OR FEE NUMBER
A MC _____	_____	_____
A MC _____	_____	_____
A MC _____	_____	_____
A MC _____	_____	_____
A MC _____	_____	_____
A MC _____	_____	_____
A MC _____	_____	_____
A MC _____	_____	_____
A MC _____	_____	_____
A MC _____	_____	_____

CLAIMANT'S NAME: Tom Mills

ADDRESS: P.O. Box 20238 CITY: Wickenburg STATE: Az

CHECK HERE IF THIS IS A CHANGE OF ADDRESS PHONE: (520) 684 2737 ZIP: 85358

SIGNATURE: Donald H Blackburn agent  
TO RECORD WITH THE COUNTY, ONE CLAIMANT OR THE AGENT MUST SIGN

LIST ALL ADDITIONAL OWNERS ON REVERSE SIDE OF THIS FORM

FOR OFFICIAL USE ONLY  
ENTERED INTO COMPUTER: 9-28-96 JB MH  
DATE INITIALS VERIFIED

TIME STAMP  
RECEIVED  
BLM AZ STATE OFFICE  
Aug 28 2 32 PM '96  
PHOENIX, ARIZONA

\* AMO 336033 and 336034 closed  
Refund authorized



43 CFR 3833.0-5(e) (August 30, 1994) REQUIRES THAT THE NAMES OF ALL OF THE OWNERS AND THEIR CURRENT ADDRESSES SHALL BE IDENTIFIED ON ALL INSTRUMENTS REQUIRED TO BE RECORDED OR FILED BY THE REGULATIONS, 43 CFR SUBPART 3833.

CLAIMANT'S NAME: \_\_\_\_\_

ADDRESS: \_\_\_\_\_ CITY: \_\_\_\_\_ STATE: \_\_\_\_\_

CHECK HERE IF THIS IS CHANGE OF ADDRESS      PHONE: ( \_\_\_\_\_ ) \_\_\_\_\_ ZIP: \_\_\_\_\_

CLAIMANT'S NAME: \_\_\_\_\_

ADDRESS: \_\_\_\_\_ CITY: \_\_\_\_\_ STATE: \_\_\_\_\_

CHECK HERE IF THIS IS CHANGE OF ADDRESS      PHONE: ( \_\_\_\_\_ ) \_\_\_\_\_ ZIP: \_\_\_\_\_

CLAIMANT'S NAME: \_\_\_\_\_

ADDRESS: \_\_\_\_\_ CITY: \_\_\_\_\_ STATE: \_\_\_\_\_

CHECK HERE IF THIS IS CHANGE OF ADDRESS      PHONE: ( \_\_\_\_\_ ) \_\_\_\_\_ ZIP: \_\_\_\_\_

CLAIMANT'S NAME: \_\_\_\_\_

ADDRESS: \_\_\_\_\_ CITY: \_\_\_\_\_ STATE: \_\_\_\_\_

CHECK HERE IF THIS IS CHANGE OF ADDRESS      PHONE: ( \_\_\_\_\_ ) \_\_\_\_\_ ZIP: \_\_\_\_\_

CLAIMANT'S NAME: \_\_\_\_\_

ADDRESS: \_\_\_\_\_ CITY: \_\_\_\_\_ STATE: \_\_\_\_\_

CHECK HERE IF THIS IS CHANGE OF ADDRESS      PHONE: ( \_\_\_\_\_ ) \_\_\_\_\_ ZIP: \_\_\_\_\_

CLAIMANT'S NAME: \_\_\_\_\_

ADDRESS: \_\_\_\_\_ CITY: \_\_\_\_\_ STATE: \_\_\_\_\_

CHECK HERE IF THIS IS CHANGE OF ADDRESS      PHONE: ( \_\_\_\_\_ ) \_\_\_\_\_ ZIP: \_\_\_\_\_

CLAIMANT'S NAME: \_\_\_\_\_

ADDRESS: \_\_\_\_\_ CITY: \_\_\_\_\_ STATE: \_\_\_\_\_

CHECK HERE IF THIS IS CHANGE OF ADDRESS      PHONE: ( \_\_\_\_\_ ) \_\_\_\_\_ ZIP: \_\_\_\_\_

**MAINTENANCE FEE PAYMENT**

**\$100.00 MAINTENANCE FEE PAYMENT DUE ON OR BEFORE AUGUST 31, 1996  
IN LIEU OF ASSESSMENT WORK FOR THE UPCOMING ASSESSMENT  
YEAR BEGINNING SEPTEMBER 1 OF THE YEAR NOTED ABOVE.**

BUREAU OF LAND MANAGEMENT  
ARIZONA STATE OFFICE  
3707 NORTH 7TH STREET  
PHOENIX, AZ 85014 (OR)  
P.O. BOX 16563, PHOENIX, AZ 85011

300253

---

COUNT: 8 \$ 800.<sup>00</sup> INT: KC  
FOR OFFICIAL USE ONLY

THE CLAIMS ARE SITUATED IN Yavapai COUNTY,  
ARIZONA.

**BLM SERIAL NUMBERS** **NAMES OF CLAIMS OR SITES**

A MC 300253 THRU A MC 300260 SMR #1 thru 8

COUNTY BOOK/DOCKET \_\_\_\_\_, PAGE(S) OR FEE NO(S) \_\_\_\_\_

A MC \_\_\_\_\_ THRU A MC \_\_\_\_\_

COUNTY BOOK/DOCKET \_\_\_\_\_, PAGE(S) OR FEE NO(S) \_\_\_\_\_

(OR) IF NOT CONSECUTIVE NUMBERS LIST SEPARATELY BELOW:

BLM SERIAL NUMBERS	NAME OF CLAIMS/SITES	COUNTY BOOK/DOCKET & PAGE OR FEE NUMBER
A MC <u>300253</u>	<u>SMR # 1</u>	<u>2222 621-636</u>
A MC <u>300254</u>	<u>SMR # 2</u>	<u>2222 621-636</u>
A MC <u>300255</u>	<u>SMR # 3</u>	<u>2222 621-636</u>
A MC <u>300256</u>	<u>SMR 4</u>	<u>2222 621-636</u>
A MC <u>300257</u>	<u>SMR # 5</u>	<u>2222 621-636</u>
A MC <u>300258</u>	<u>SMR # 6</u>	<u>2222 621-636</u>
A MC <u>300259</u>	<u>SMR # 7</u>	<u>2222 621-636</u>
A MC <u>300260</u>	<u>SMR # 8</u>	<u>2222 621-636</u>
A MC _____	_____	_____
A MC _____	_____	_____

CLAIMANT'S NAME: Tom Mills

ADDRESS: P.O. Box 20238 CITY: Wickenburg STATE: AZ

CHECK HERE IF THIS IS A CHANGE OF ADDRESS PHONE: (520) 684-2737 ZIP: 85358

SIGNATURE: Donald H Blackburn Agent  
TO RECORD WITH THE COUNTY, ONE CLAIMANT OR THE AGENT MUST SIGN

LIST ALL ADDITIONAL OWNERS ON REVERSE SIDE OF THIS FORM

**FOR OFFICIAL USE ONLY**

ENTERED INTO COMPUTER: 9-28-96 JJ MM  
DATE INITIALS VERIFIED

TIME STAMP

RECEIVED  
BLM, AZ STATE OFFICE  
Aug 28 2 32 PM '96  
PHOENIX, ARIZONA

43 CFR 3833.0-5(e) (August 30, 1994) REQUIRES THAT THE NAMES OF ALL OF THE OWNERS AND THEIR CURRENT ADDRESSES SHALL BE IDENTIFIED ON ALL INSTRUMENTS REQUIRED TO BE RECORDED OR FILED BY THE REGULATIONS, 43 CFR SUBPART 3833.

CLAIMANT'S NAME: Thomas O. Mills  
ADDRESS: P.O. Box 20238 CITY: Wickenburg STATE: Az  
 CHECK HERE IF THIS IS CHANGE OF ADDRESS PHONE: (520) 684 2737 ZIP: 85358

CLAIMANT'S NAME: \_\_\_\_\_  
ADDRESS: \_\_\_\_\_ CITY: \_\_\_\_\_ STATE: \_\_\_\_\_  
 CHECK HERE IF THIS IS CHANGE OF ADDRESS PHONE: ( ) ZIP: \_\_\_\_\_

CLAIMANT'S NAME: \_\_\_\_\_  
ADDRESS: \_\_\_\_\_ CITY: \_\_\_\_\_ STATE: \_\_\_\_\_  
 CHECK HERE IF THIS IS CHANGE OF ADDRESS PHONE: ( ) ZIP: \_\_\_\_\_

CLAIMANT'S NAME: \_\_\_\_\_  
ADDRESS: \_\_\_\_\_ CITY: \_\_\_\_\_ STATE: \_\_\_\_\_  
 CHECK HERE IF THIS IS CHANGE OF ADDRESS PHONE: ( ) ZIP: \_\_\_\_\_

CLAIMANT'S NAME: \_\_\_\_\_  
ADDRESS: \_\_\_\_\_ CITY: \_\_\_\_\_ STATE: \_\_\_\_\_  
 CHECK HERE IF THIS IS CHANGE OF ADDRESS PHONE: ( ) ZIP: \_\_\_\_\_

CLAIMANT'S NAME: \_\_\_\_\_  
ADDRESS: \_\_\_\_\_ CITY: \_\_\_\_\_ STATE: \_\_\_\_\_  
 CHECK HERE IF THIS IS CHANGE OF ADDRESS PHONE: ( ) ZIP: \_\_\_\_\_

CLAIMANT'S NAME: \_\_\_\_\_  
ADDRESS: \_\_\_\_\_ CITY: \_\_\_\_\_ STATE: \_\_\_\_\_  
 CHECK HERE IF THIS IS CHANGE OF ADDRESS PHONE: ( ) ZIP: \_\_\_\_\_

**MAINTENANCE FEE PAYMENT**

\$100.00 MAINTENANCE FEE PAYMENT DUE ON OR BEFORE AUGUST 31, 1996  
 IN LIEU OF ASSESSMENT WORK FOR THE UPCOMING ASSESSMENT  
 YEAR BEGINNING SEPTEMBER 1 OF THE YEAR NOTED ABOVE.

BUREAU OF LAND MANAGEMENT  
 ARIZONA STATE OFFICE  
 3707 NORTH 7TH STREET  
 PHOENIX, AZ 85014 (OR)  
 P.O. BOX 16563, PHOENIX, AZ 85011

<u>339240</u>		
COUNT: <u>2</u>	\$ <u>100.<sup>00</sup></u>	INT: <u>100</u>
FOR OFFICIAL USE ONLY		

THE CLAIMS ARE SITUATED IN Maricopa COUNTY, ARIZONA.

<b>BLM SERIAL NUMBERS</b>	<b>NAMES OF CLAIMS OR SITES</b>
A MC <u>339240</u> THRU A MC <u>339241</u>	<u>RE65 + RE 66</u>
COUNTY BOOK/DOCKET _____, PAGE(S) OR FEE NO(S) <u>96-0158105</u>	
A MC _____ THRU A MC _____	<u>96-0158106</u>
COUNTY BOOK/DOCKET _____, PAGE(S) OR FEE NO(S) _____	

(OR) IF NOT CONSECUTIVE NUMBERS LIST SEPARATELY BELOW:

BLM SERIAL NUMBERS	NAME OF CLAIMS/SITES	COUNTY BOOK/DOCKET & PAGE OR FEE NUMBER
A MC _____	_____	_____
A MC _____	_____	_____
A MC _____	_____	_____
A MC _____	_____	_____
A MC _____	_____	_____
A MC _____	_____	_____
A MC _____	_____	_____
A MC _____	_____	_____
A MC _____	_____	_____
A MC _____	_____	_____

CLAIMANT'S NAME: \_\_\_\_\_

ADDRESS: Po Box 20238 CITY: Wickenburg STATE: Az

CHECK HERE IF THIS IS A CHANGE OF ADDRESS PHONE: (520) 684 2737 ZIP: 85358

SIGNATURE: Donald H Blackburn Agent  
 TO RECORD WITH THE COUNTY, ONE CLAIMANT OR THE AGENT MUST SIGN

TIME STAMP

LIST ALL ADDITIONAL OWNERS ON REVERSE SIDE OF THIS FORM

<b>FOR OFFICIAL USE ONLY</b>		
ENTERED INTO COMPUTER: _____	_____	_____
DATE	INITIALS	VERIFIED

PHOENIX, ARIZONA  
 Aug 28 2 31 PM '96  
 RECEIVED  
 BLM AZ STATE OFFICE

43 CFR 3833.0-5(e) (August 30, 1994) REQUIRES THAT THE NAMES OF ALL OF THE OWNERS AND THEIR CURRENT ADDRESSES SHALL BE IDENTIFIED ON ALL INSTRUMENTS REQUIRED TO BE RECORDED OR FILED BY THE REGULATIONS, 43 CFR SUBPART 3833.

CLAIMANT'S NAME: \_\_\_\_\_

ADDRESS: \_\_\_\_\_ CITY: \_\_\_\_\_ STATE: \_\_\_\_\_

CHECK HERE IF THIS IS CHANGE OF ADDRESS      PHONE: (\_\_\_\_) \_\_\_\_\_ ZIP: \_\_\_\_\_

CLAIMANT'S NAME: \_\_\_\_\_

ADDRESS: \_\_\_\_\_ CITY: \_\_\_\_\_ STATE: \_\_\_\_\_

CHECK HERE IF THIS IS CHANGE OF ADDRESS      PHONE: (\_\_\_\_) \_\_\_\_\_ ZIP: \_\_\_\_\_

CLAIMANT'S NAME: \_\_\_\_\_

ADDRESS: \_\_\_\_\_ CITY: \_\_\_\_\_ STATE: \_\_\_\_\_

CHECK HERE IF THIS IS CHANGE OF ADDRESS      PHONE: (\_\_\_\_) \_\_\_\_\_ ZIP: \_\_\_\_\_

CLAIMANT'S NAME: \_\_\_\_\_

ADDRESS: \_\_\_\_\_ CITY: \_\_\_\_\_ STATE: \_\_\_\_\_

CHECK HERE IF THIS IS CHANGE OF ADDRESS      PHONE: (\_\_\_\_) \_\_\_\_\_ ZIP: \_\_\_\_\_

CLAIMANT'S NAME: \_\_\_\_\_

ADDRESS: \_\_\_\_\_ CITY: \_\_\_\_\_ STATE: \_\_\_\_\_

CHECK HERE IF THIS IS CHANGE OF ADDRESS      PHONE: (\_\_\_\_) \_\_\_\_\_ ZIP: \_\_\_\_\_

CLAIMANT'S NAME: \_\_\_\_\_

ADDRESS: \_\_\_\_\_ CITY: \_\_\_\_\_ STATE: \_\_\_\_\_

CHECK HERE IF THIS IS CHANGE OF ADDRESS      PHONE: (\_\_\_\_) \_\_\_\_\_ ZIP: \_\_\_\_\_

CLAIMANT'S NAME: \_\_\_\_\_

ADDRESS: \_\_\_\_\_ CITY: \_\_\_\_\_ STATE: \_\_\_\_\_

CHECK HERE IF THIS IS CHANGE OF ADDRESS      PHONE: (\_\_\_\_) \_\_\_\_\_ ZIP: \_\_\_\_\_

UNITED STATES  
DEPARTMENT OF THE INTERIOR  
BUREAU OF LAND MANAGEMENT

RECEIPT AND ACCOUNTING ADVICE

NO. 2263596 04

TC/AZ 08/28/96

Subject: CLAIM MAINTENANCE FEE 1997 - 18

2 78 13

1,800.00

Applicant:

TOM MILLS  
BOX 20238  
WICKENBURG AZ 85358

Remitter: CK 1380  
520-684-5065

Assignor:

LEASE MANAGEMENT DATA									
<input type="checkbox"/> NEW <input type="checkbox"/> UPDATE <input type="checkbox"/> PAYMENT									
ORIGINAL SERIAL NO.	ASG.	TYPE	ST.	CTY.	FUND SYMBOL			ACRES/UNITS	RATE
300253, ET AL									
AMOUNT	ANV. DATE	EXP. DATE	BILL CYC.	S/C	DISTRICT	NEXT BILL	MISC. DATA	U of M	ACTUAL UNITS
ASSIGNMENT SERIAL NO.	ASG.	TYPE	ST.	CTY.	FUND SYMBOL			ACRES/UNITS	RATE
AMOUNT	ANV. DATE	EXP. DATE	BILL CYC.	S/C	DISTRICT	NEXT BILL	MISC. DATA	U of M	ACTUAL UNITS

APPLY REMITTANCE

ACTION	FUND SYMBOL	CTY.	AMOUNT
FILING FEE			
RENTAL			
UNEARNED			
REFUND			200.00
TOTAL			
AMOUNT DUE			

Remarks:

AMC 336033 and 336034  
Closed.  
Refund Authorized

BY:

*Mary B Hyde*

DATE:

11/15/96

Lease in Escrow?  
 KGS?                      Of Interest?  
 Auto Escalates?            Operating Rights?  
 Auto Renew?                Operator  
    Bond Filed?

**FOR MMS USE ONLY**

BILLEE	FOREST REFUGE
NUMBER	
OCS SECTION	
CODE	

**NOTICE!!**

**These documents have been scanned!**

**Do not place un-scanned documents beneath this notice!**

**Do not remove this notice from this file!**

GPO Jacket No. 560-102  
Print Order 61540  
Rise Business Services, LLC  
Job=AZ15 7/15/2019



Box Number= AZ15164



Claim Begin-End: AMC336027-AMC336034

**5 Miscellaneous**



AZ15164-10

AMC335259-AMC337099

300253

336027

Bureau of Land Management  
One N. Central Avenue Suite 800  
Phoenix, Arizona 85004

March 21st. 2016

Dear Sir,

I have moved and my new address is:

Thomas O. Mills  
4030 Legato Lane  
Efland, N.C. 27243

My phone number and e-mail will remain the same.

My old address was 1754 Brahma Street, Paso Robles, Ca. 93446

The claim numbers are:

SMR 1 through 8.....AMC#300253 through AMC#300260     &  
SMH 1 through 6.....AMC#336027 through AMC#336032

All the best.



Thomas O. Mills  
805-591-9298



PHOENIX, ARIZONA  
2016 MAR 24 P 3:10  
RECEIVED  
BLM PHOENIX OFFICE



THOMAS O. MILLS

4030 LEGATO LANE  
EFLAND, N. C. 27243

GREENSBORO  
NC 274  
21 MAR '16  
PM 6 L

RECEIVED  
BLM AZ STATE OFFICE

2016 MAR 24 P 3:10

PHOENIX, ARIZONA

BUREAU OF LAND MANAGEMENT

ONE N. CENTRAL AVENUE SUITE 800  
PHOENIX, ARIZONA 85004



FOREVER

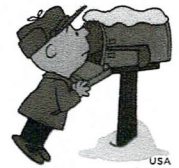

85004442700

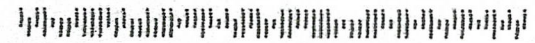

336027

*March 2, 2006*

*Bureau Of Land Management  
Arizona State Office  
222 North Central Avenue  
Phoenix, Arizona 805004-2203*

*Dear Sir:*

*Please change my address on:*

*Amc 336027 thru amc 336032 SMH*

*Amc 300253 thru amc 300260 SMR*

*To: Thomas O. Mills  
1754 Brahma Street  
Paso Robles, Ca 93446*

*Phone: 805 591-9298*

*Thanks*

*Thomas O. Mills*

*Thomas O. Mills*

ENTERED IN COMPUTER

RS 3/10/06

New Address:  
Thomas O. & Glenda (Gigi) Mills  
1754 Brahma Street  
Paso Robles, Ca. 93446



RECEIVED  
BUREAU OF  
LAND MANAGEMENT

2006 MAR -6 P 12:57

ARIZONA  
STATE OFFICE  
PHOENIX, ARIZONA

B. L. M.  
ARIZONA STATE OFFICE  
222 N. Central Ave.  
Phoenix, ARIZONA

85004-2203

85004-2203

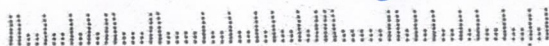

AMC 300253  
336027

**Bureau of Land Management  
222 N. Central Ave.  
Phoenix, Arizona 85004**

**August 31, 2005**

**Dear Sir:**

**Please change my address to: Thomas O. Mills  
8435 Paseo De Caballo  
Atascadero, Ca. 93422**

**On the following claims:**

**Amc 336027 through amc 336032 and**

**Amc 300253 through amc 300260.**

RECEIVED  
B.L.M. AZ STATE OFFICE  
2005 AUG 31 P 1:44  
PHOENIX, ARIZONA

**Thank You,**

*Thomas O. Mills*

**Thomas O. Mills Home phone 805-464-0684 cell 817-313-6422**

# Customer Name Update Screen

System ID:MC

Name: MILLS THOMAS O

Lookup

Proprietor #: 49761

Renumber To:

Category:

Address: 8435 PASEO DE CABALLO

City: ATASCADERO

State: CA

Zip: 93422

Save

View

Delete

Renumber

Customer details successfully saved for Customer Id 49761

# Customer Name Update Screen

System ID:MC

Name: MILLS THOMAS O

Lookup

Proprietor #: 49761

Renumber To:

Category:

Address: 2245 E KNOLL ST

City: MESA

State: AZ

Zip: 85213

*OLD ADDRESS*

Save

View

Delete

Renumber

***Bureau of Land Management  
Arizona State Office  
222 North Central Avenue  
Phoenix, Arizona***

***Dear Sir,***

***My new address is: Thomas O. Mills  
2245 E. Knoll Street  
Mesa, Arizona 85213***

***My new phone number is: 480-649-4364***

***AMC 336027 thru AMC 336032 SMH***

***AMC 300253 thru AMC 300260 SMR***

***Thank you.***

***Thomas O. Mills***

*Thomas O. Mills*

ARIZONA  
STATE OFFICE  
PHOENIX, ARIZONA

2002 JAN -9 A 9:26

RECEIVED  
BUREAU OF  
LAND MANAGEMENT

336027  
300253

RECEIVED  
BUREAU OF  
LAND MANAGEMENT

Dec 21 10 10 AM '98

ARIZONA  
STATE OFFICE  
PHOENIX, ARIZONA

December 15, 1998

Miss Mary Jo Yoas  
Bureau of Land Management  
222 North Central Avenue  
Phoenix, Arizona 85004-2203

Dear Mary,

I received your letter of December 11, 1998 concerning payment of my Maintenance Fee on August 12, 1998.

I inadvertently identified my old AMC numbers (AMC 261039 through AMC 261044) instead of the correct numbers AMC 336027 through AMC 336032.

I am sorry for this error on my part and would appreciate you making the appropriate correction

Also, the spelling of my name is Thomas O. Mills

Thank You.

Merry X-mas and Happy New Year

Sincerely,

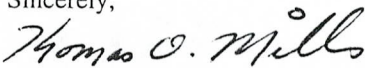

Thomas O. Mills  
1202 San Augustine Ct.  
Southlake, Texas 76092  
817-421-1994



DEC 13, 1998 11:41AM DUMP 1&2 FT WORTH TX NO. 2093

# ***Transportation Service & Support***

**Burlington Northern Santa Fe Railroad**  
3001 Lou Menk Boulevard, Ft Worth, Texas 76131-2815

ATTN: MARY Jo Yoas FAX# 602-417-9490

FROM: Thomas O. Mills

DATE: 12/15/98

COMMENTS: Thanks & Merry X-mas

---

---

---

---

---

WE ARE TRANSMITTING 2 PAGES, INCLUDING  
THIS COVER SHEET. IF YOU DO NOT RECEIVE ALL  
COPIES, PLEASE CALL: (817) 317 - 1257.

OFFICIAL COPIES /CF/ /SD READ/ /GROUP/ /SECTION/ /AUTHOR/

*mjyoas*  
*12/11/98*

3800 (952.3) MJY  
A MC 261039

**DEC 11 1998**

Mr. Thomas O. Mills  
1202 San Augustine  
Southlake, Texas 76092

Dear Mr. Mills:

On August 12, 1998, your 1999 Maintenance Fee Payment was received in this office.

According to the Bureau of Land Management records, the mining claims identified as SMH Claims #1 through #6, (A MC 261039 through A MC 261044), were closed by a decision dated May 23, 1995. A copy of the closure decision is enclosed for reference.

Because the claims are closed, a refund of \$600 will be applied to your credit card.

If you need additional information, please contact me at the address above, or by telephone at (602) 417-9518.

Sincerely,

**/s/ Mary Jo Yoas**

Mary Jo Yoas  
Supervisor, Lands and Minerals Operations

Enclosure

MJYOAS:ers:12/10/98:AMC261039

December 15, 1998

Miss Mary Jo Yoas  
Bureau of Land Management  
222 North Central Avenue  
Phoenix, Arizona 85004-2203

Dear Mary,

I received your letter of December 11, 1998 concerning payment of my Maintenance Fee on August 12, 1998.

I inadvertently identified my old AMC numbers (AMC 261039 through AMC 261044) instead of the correct numbers AMC 336027 through AMC 336032.

I am sorry for this error on my part and would appreciate you making the appropriate correction

Also, the spelling of my name is Thomas O. Mills

Thank You.

Merry X-mas and Happy New Year

Sincerely,

*Thomas O. Mills*

Thomas O. Mills  
1202 San Augustine Ct.  
Southlake, Texas 76092  
817-421-1994

3800 (933) MJY  
A MC 336027

*mjy*  
*12/14/95*

DEC 14 1995

CERTIFIED MAIL - RETURN RECEIPT REQUESTED

DECISION

Tomas Mills	:	SMH #7 and SMH #8
c/o Donald A. Blackburn	:	Lode Claims
P.O. Box 20238	:	
Wickenburg, Arizona 85358	:	

Mining Claims Declared Null and Void  
Ab Initio

On November 20, 1995, the above-referenced mining claims were located. Pursuant to the requirements of the Federal Land Policy and Management Act of 1976, 43 U.S.C. 1744, and the implementing regulations in 43 CFR 3833.1-2, a notice of location was filed for recording with the Arizona State Office, Bureau of Land Management (BLM), on November 21, 1995.

The Notice of Mining Claim Location showed the claims to be located in the SE $\frac{1}{4}$  of sec. 28, T. 12 N., R. 9 W., Gila and Salt River Meridian, Arizona. The accompanying maps, however, show both the mining claims to be located within the SW $\frac{1}{4}$  of sec. 28, T. 12 N., R. 9 W., Gila and Salt River Meridian, Arizona.

According to the BLM public records, the entire S $\frac{1}{2}$  (surface and minerals) of the subject section were conveyed to the State of Arizona on February 19, 1937 (copy enclosed). At the time of location, the lands were not open to the location of mining claims. The subject mining claims are invalid and are hereby declared null and void ab initio.

"Mining claims located on land closed to mineral entry are null and void ab initio as a matter of law, and no property rights are created. Therefore, no contest proceeding or hearing is required prior to a Decision holding a claim null and void ab initio." Fletcher De Fisher, Fisher International, Inc., 93 IBLA 68 (1986).

This Decision may be appealed to the Interior Board of Land Appeals, Office of the Secretary, in accordance with the regulations contained in 43 CFR, Part 4 and the enclosed Form 1842-1. If an appeal is taken, your notice of appeal must be filed in this office (at the above address) within 30 days from receipt of this Decision. The appellant has the burden of showing that the Decision appealed from is in error.

Is your RETURN ADDRESS completed on the reverse?

Items 1 and/or 2 for additional services.

Items 3, 4a, and 4b.

Write your name and address on the reverse of this form so that we can return this to you.

- Attach this form to the front of the mailpiece, or on the back if space does not permit.
- Write "Return Receipt Requested" on the mailpiece below the article number.
- The Return Receipt will show to whom the article was delivered and the date delivered.

I also wish to receive the following services (for an extra fee):

1.  Addressee's Address
2.  Restricted Delivery

Consult postmaster for fee.

3. Article Addressed to:

Tomas Mills  
c/o Donald A. Blackburn  
P.O. Bix 20238  
Wickenburg, AZ 85358

3800 (933) MJY A MC 336027

4a. Article Number

764523

4b. Service Type

- |  |   |
|--|---|
| <input type="checkbox"/> Registered                                | <input checked="" type="checkbox"/> Certified |
| <input type="checkbox"/> Express Mail                              | <input type="checkbox"/> Insured              |
| <input checked="" type="checkbox"/> Return Receipt for Merchandise | <input type="checkbox"/> COD                  |

7. Date of Delivery

5. Received By: (Print Name)

*[Handwritten Signature]*

6. Signature: (Addressee or Agent)

X

8. Addressee's Address (Only if requested and fee is paid)

Thank you for using Return Receipt Service

UNITED STATES POSTAL SERVICE

12/18/95



Post.  
USPS  
Permit No.

● Print your name, address, and ZIP Code in this box ●

Bureau of Land Management  
Arizona State Office (933A)  
P.O.Box 16563  
Phoenix AZ 85011-6563



If you wish to file a petition pursuant to regulation 43 CFR 4.21 (58 FR 4939, January 19, 1993) or 43 CFR 2804.1 for a stay of the effectiveness of this Decision during the time that your appeal is being reviewed by the Board, the petition for a stay must accompany your notice of appeal. A petition for a stay is required to show sufficient justification based on the standards listed below. Copies of the notice of appeal and petition for a stay must also be submitted to each party named in this Decision and to the Interior Board of Land Appeals and to the appropriate Office of the Solicitor (see 43 CFR 4.413) at the same time the original documents are filed with this office. If you request a stay, you have the burden of proof to demonstrate that a stay should be granted.

#### Standards for Obtaining a Stay

Except as otherwise provided by law or other pertinent regulation, a petition for a stay of a decision pending appeal shall show sufficient justification based on the following standards:

- (1) The relative harm to the parties if the stay is granted or denied,
- (2) The likelihood of the appellant's success on the merits,
- (3) The likelihood of immediate and irreparable harm if the stay is not granted, and
- (4) Whether the public interest favors granting the stay.

If you have any questions, please call Mary Jo Yoas at (602) 650-0518.

*Mary Jo Yoas*  
 Mary Jo Yoas  
 Chief, Lands and Minerals  
 Operations Section

Enclosures

MJYoas:lj:12-13-95:336027.AMC

2/5/96  
 Report Amended  
 \$250<sup>00</sup>  

LIST No 3

Navajo Exchange Selections  
made at May 23, 1930, in ~~the~~  
State of Arizona

Embracing 2,809.61 acres in the

Phoenix Land District

Approved: Feb. 19, 1937

~~Approved: Feb. 19, 1937 - All except 247.61 acres in the  
Phoenix Land District and put in 1937. 1930~~



APPROVED LIST NO. 3 OF SELECTIONS IN LIEU OF STATE LANDS WITHIN  
 the Western Navajo Indian Reservation, in the Phoenix Land District, in lieu of the  
 tracts selected by the State of Arizona, in the Phoenix Land District, in lieu of the  
 tracts approved May 25, 1930 (46 Stat. 378), as amended by the Act of February 21, 1931 (46 Stat. 1204).

CLASS OF LAND	DESCRIPTION OF TRACT	SECTION	TOWNSHIP	RANGE	ACRES	VALUATION	TOTAL AREA OF STATE LANDS (Acres)	
ADDITION to Navajo Indian Reservation	Part of lot 2	4	27 N.	7 E. D. & S. R.	37			
	Part of lot 3	4	27 N.	7 E.	11 01			
	Part of lot 4	4	27 N.	7 E.	13 76			
	Part of lot 1	30	27 N.	7 E.	28			
	Part of lot 2	30	27 N.	7 E.	11			
	Part of lot 3	30	27 N.	7 E.	19			
	Part of lot 4	30	27 N.	7 E.	26			
	Part of lot 4	4	27 N.	8 E.	32	26 30		
	Part of lot 1	30	27 N.	7 E.	49 76			
	Part of lot 2	30	27 N.	7 E.	50 00			
	Part of lot 3	30	27 N.	7 E.	50 00			
	Part of lot 4	30	27 N.	7 E.	50 00			
	Part of lot 1	18	27 N.	7 E.	7 13			
	Part of lot 2	18	27 N.	7 E.	49 60			
	Lot 3, 4	18	27 N.	7 E.	59 56			
	Part of lot 1	4	27 N.	8 E.	40 00			
	Part of lot 2	4	27 N.	8 E.	40 00			
	Part of lot 3	4	27 N.	8 E.	40 00			
	Part of lot 4	4	27 N.	8 E.	40 00			
	Part of lot 1	6	27 N.	8 E.	40 00			
Part of lot 2	6	27 N.	8 E.	40 00				
SE 1/4, SW 1/4, NE 1/4, NW 1/4	34	27 N.	7 E.	596 05	December 27, 1932	072926	SE 1/4, Lots 1, 2, 3, 4, 5, 6, 7, 8, 9, 10, 11, 12	
SE 1/4, SW 1/4, NE 1/4, NW 1/4	28	27 N.	7 E.	440 00	December 27, 1932	072917	NE 1/4, SE 1/4, SW 1/4, NW 1/4	
SE 1/4, SW 1/4, NE 1/4, NW 1/4	28	27 N.	7 E.	600 00	December 27, 1932	072918	SE 1/4, SW 1/4, NE 1/4, NW 1/4	
SE 1/4	20	27 N.	8 E.	320 00	December 27, 1932	072918	SE 1/4	
SE 1/4, SW 1/4, NE 1/4, NW 1/4	6	27 N.	8 E.	200 00			SE 1/4, SW 1/4, NE 1/4, NW 1/4	
SE 1/4, SW 1/4, NE 1/4, NW 1/4	18	27 N.	8 E.	240 00			SE 1/4, SW 1/4, NE 1/4, NW 1/4	
SE 1/4, SW 1/4, NE 1/4, NW 1/4	30	27 N.	8 E.	120 00			SE 1/4, SW 1/4, NE 1/4, NW 1/4	
Part of lot 6	6	27 N.	7 E.	39 94	December 27, 1932	072921	Part of lot 6	
Part of lot 4	6	27 N.	7 E.	39 94	December 27, 1932	072923	Part of lot 4	
Part of lot 1	6	26 N.	8 E.	75			Part of lot 1	
Part of lot 1	4	27 N.	8 E.	01			Part of lot 1	
Lots 3, 4	18	27 N.	8 E.	75 74			Lots 3, 4	
Lots 1, 2, 3, 4	30	27 N.	8 E.	150 80	227 32	April 10, 1933	072922	Lots 1, 2, 3, 4
TOTAL							2,809 61	

THE WESTERN NAVAJO INDIAN RESERVATION  
 corresponding tracts assigned as bases for the selections made under the provisions of the Act of

DATE OF FILING	SECTION	TOWNSHIP	RANGE	ACRES	VALUATION	DESCRIPTION OF TRACTS-SELECTED
December 27, 1932	072909	Lot 1	30	7 8. 10 E. 6. 48. E.		Lot 1
December 27, 1932	072926	SE 1/4	30	596 05		SE 1/4, Lots 1, 2, 3, 4, 5, 6, 7, 8, 9, 10, 11, 12
December 27, 1932	072917	NE 1/4, SE 1/4, SW 1/4, NW 1/4	28	440 00		NE 1/4, SE 1/4, SW 1/4, NW 1/4
December 27, 1932	072918	SE 1/4, SW 1/4, NE 1/4, NW 1/4	28	600 00		SE 1/4, SW 1/4, NE 1/4, NW 1/4
December 27, 1932	072918	SE 1/4	20	320 00		SE 1/4
December 27, 1932	072921	Part of lot 6	6	39 94		Part of lot 6
December 27, 1932	072923	Part of lot 4	6	39 94		Part of lot 4
April 10, 1933	072922	Lots 1, 2, 3, 4	30	227 32		Lots 1, 2, 3, 4

## DEPARTMENT OF THE INTERIOR

## GENERAL LAND OFFICE

Washington, D. C.

FEB 17 1937

It is hereby certified that the tracts described in this list, No. 3, are embraced in the original selection lists, now on file in this office, of lands selected by the State of Arizona, in the Phoenix Land District, embracing 2,809.61 acres, in lieu of lands which were acquired by the State as indemnity school lands, through the selection, approval and certification thereof pursuant to the enabling act of June 20, 1910 (36 Stat. 557), and which were thereafter included within the Western Navajo Indian Reservation, subject to prior valid rights and claims thereto, by the act of Congress approved May 23, 1930 (46 Stat. 378), as amended by the act of February 21, 1931 (46 Stat. 1204). Certificates by the State officer and the proper county recorder have been furnished showing nonencumbrance of said base lands by the State. These exchange selections are authorized by said acts of 1930 and 1931 which provide that the lieu selections by the State be made in the same manner as is provided for in the enabling act, the selections under the enabling act being governed by the regulations approved by the Department June 23, 1910 (39 L. B. 39).

It is further certified that the lands offered as a basis for the exchange and those selected in lieu thereof have been examined and compared with the township plat and tract books in this office; that the selected lands have been found to be subject to selection by the State, being surveyed, public lands, not mineral in character, within the limits of said State, equal in area to those relinquished, and free from adverse claims of record. Some of the selected lands are within Grazing District No. 4, established February 14, 1936, subsequent to the completion of the selections and are not affected thereby. Executive Order No. 6910 of November 26, 1934, temporarily withdrew all vacant, unreserved, unappropriated, public lands in the State of Arizona from settlement, location, sale or entry, in furtherance of the purposes of the act of June 20, 1934 (48 Stat. 1269), which withdrawal was made subject to existing valid rights. Some of these selections were completed prior to said withdrawal and are not affected thereby (255 U. S. 228). One selection was filed and allowed prior to said withdrawal but was not completed until after the date thereof. However, in view of the departmental decision of April 4, 1935 (A 18519), in the case of the indemnity school land selection list Phoenix 072751 (55 L. B. 249) such withdrawal is not considered a bar to the approval of the selection. The selected lands are not embraced in any other subsisting withdrawal or reservation of record. Reports have been received from the Geological Survey and from Special Agents indicating that the selected lands are not valuable for coal or other minerals.

It is therefore recommended that this list, embracing 2,809.61 acres, be approved subject to any valid intervening rights existing at date of selection but excepting and reserving unto the United States rights of way over and across said selected lands for ditches or canals constructed by their authority, all as directed by the act of Congress approved August 30, 1890 (26 Stat. 391).

*J. H. Smith*  
Acting Assistant Commissioner.

Approved: FEB 19 1937

*J. H. Smith*  
First Assistant Secretary

DEC. 8, 1995

TELEPHONE CONVERSATION

MR. THOMAS MILLS,  
913 4378 0155 2:35P.M.

MR. MILLS INFORMED THAT SMH # 7 AMC 336033, AND SMH #8 AMC336034  
WERE DEPICTED IN THE SW1/4 OF SEC. 28 WHICH IS STATE SURFACE AND  
MINERALS. ALSO THAT THE LOCATION NOTICE SAID SE1/4 OF SEC. 28.

CLAIMS WILL BE DECLARED NULL AND VOID. REFUND OF \$250.00 .

DORIE MORRISON  
LLE

**NOTICE!!**

**These documents have been scanned!**

**Do not place un-scanned documents beneath this notice!**

**Do not remove this notice from this file!**

GPO Jacket No. 560-102  
Print Order 61540  
Rise Business Services, LLC  
Job=AZ15 7/15/2019



Box Number= AZ15164



Claim Begin-End: AMC336027-AMC336034

**6 Location Notices-Amendments and Supporting Documents**



AZ15164-10

AMC335259-AMC337099

MINING CLAIM STATUS REPORT

Lead Serial No. A MC 336027 THROUGH A MC 336034

No. of Lode Claims 8

STATUS CHECKED BY Tony Smith  
Enter Action Code 669

No. of Placer Claims \_\_\_\_\_

No. of Association Placer (Not Enough Locators Send Form Ltr.) \_\_\_\_\_

MTP CHECKED  (Reduced Size Copy Enclosed)

No. of Mill Sites \_\_\_\_\_

ORCA GEO CHECKED  (Copy Enclosed)

No. of Tunnel Sites \_\_\_\_\_

Timely Filed  YES NO

WILDERNESS (WA) AREA CHECKED

Service Charge Correct  YES NO (This is Curable)

WHICH WA NA

Location Fee Correct  YES NO

Maintenance Fee Correct  YES NO

Amount Paid \$ 1,080.00

Shortage \$ 0 Overage \$ 0

Over-the-Counter  Mail \_\_\_\_\_

Township(s) 12N

Range(s) 9W

Section(s) 28, 21

GENERAL JURISDICTION OF: BLM  (or) WHICH NATIONAL FOREST \_\_\_\_\_

Enter Code 880 On Split Estate Land (Show Type of Patent - SX, PX, SRHE etc) Patent 1144213 5/4/54

Mineral Reserved to US. Sec 21 SW SE. Sec 21, 28  
see 28. NWNE, NW.

Enter Code 267 For Stockraising Homestead When Proper Notice Has Been Filed  
NA

STATUS

CLAIMS PARTIALLY VOID: Private Minerals  Withdrawn \_\_\_\_\_ Other State surface

SMH #1-8 is partially on SX land. I told Mr. Mills of the conflict

CLAIMS VOID: Private Minerals \_\_\_\_\_ Withdrawn \_\_\_\_\_ Other \_\_\_\_\_

ADD: DATE RECEIVED, ACTION CODE 482, IN REMARKS: 1995, 1996, 1997, 1998

SPECIAL INSTRUCTIONS FOR DATA INPUT: \_\_\_\_\_

COMMENTS Claim SMH #7 + SMH #8. located in SW 1/4.

Location noted only SE 1/4 Sec 28. - No Federal Surface or Mine in SW of Sec 28. Claim Void. St Found

Refund \$250.00

WHEN RECORDED MAIL TO:

Tom Mills

5338 SW Irish

Topeka Kansas Zip 66610

FEE: \$ \_\_\_\_\_

COUNTY RECORDER

NOTICE OF MINING CLAIM LOCATION

1.  Location  Amendment  Placer  Lode  Millsite  Tunnelsite
2. Name of Claim: SMH #1
3. Name of Locator: Tommas Mills
4. Located in Section 21 Township 12 N Range 9 West Mining District, Eureka County, Yavapai
5. Type of Location Monument is 4 X 4 Wood Post  Type of corner monument is 4 X 4 Wood Post.
6. The bearing and distance between corner of the claim are: Beginning at the SW corner of the claim, 600 feet in a W direction to the SW corner, then 150 feet in a N direction to the NW corner, then 600 feet in a E direction to the corner, then 1600 feet in a S direction to the point of beginning.
7. The location of the claim occupies all or part of the following quarter-sections:  
Quarter-Sections SE 1/4 SW 1/4 Section(s) 21 Township(s) 12 N Range(s) 9 W
8. If Amending (relocating) or previously recorded, the claim was recorded in 1864 Docket, 900 Page, Eureka Mining District.  
BLM FMC # 261039

RECEIVED  
B.L.M. OFFICE  
ARIZONA STATE OFFICE  
NOV 21 10 18 AM '95

SIGNATURES:

Donald H Blackburn

Agent for  
Tom Mills

N  
↑

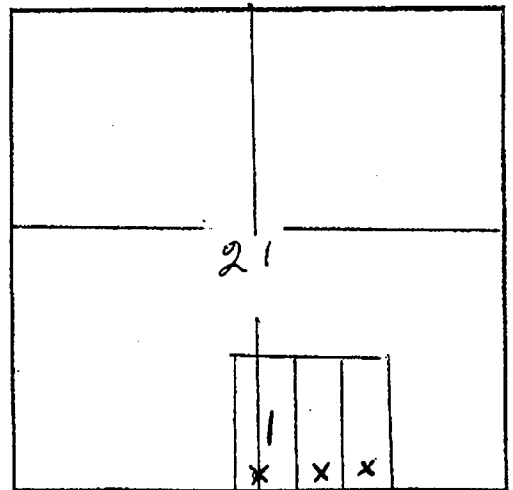

A MC 336027

- x = Location Monument
- o = Survey Market
- = Wood Posts

Date: Nov 20 - 95

WHEN RECORDED MAIL TO:

Tom Mills

5338 SW Irish

Topeka Kansas zip 66610

FEE: \$

COUNTY RECORDER

NOTICE OF MINING CLAIM LOCATION

1.  Location  Amendment  Placer  Lode  Millsite  Tunnelsite
2. Name of Claim: SMH #2
3. Name of Locator: Tommas Mills
4. Located in Section          Township 12 N Range 9 West Mining District, Eureka County, Yavapai
5. Type of Location Monument is 4 X 4 Wood Post  Type of corner monument is 4 X 4 Wood Post.
6. The bearing and distance between corner of the claim are: Beginning at the SE corner of the claim, 600 feet in a W direction to the SW corner, then 1500 feet in a N direction to the NW corner, then 600 feet in a E direction to the corner, then 1600 feet in a S direction to the point of beginning.
7. The location of the claim occupies all or part of the following quarter-sections:  
Quarter-Sections SE 1/4 Section(s) 21 Township(s) 12 N Range(s) 9 W
8. If Amending relocating or previously recorded, the claim was recorded in 1864 Docket, 903 Page, Eureka Mining District.  
BLM FMC # 261040

RECEIVED  
ARIZONA BLM  
STATE OFFICE  
NOV 21 11 10 AM '95  
A HC 336028

SIGNATURES:

Donald A Blackburn

Agent for  
Tom Mills

N  
↑

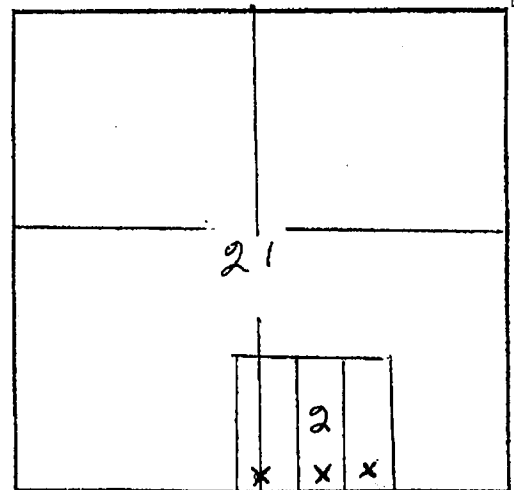

x = Location Monument

o = Survey Market

• = Wood Posts

Date: Nov 20 - 95

WHEN RECORDED MAIL | O:

Tom Mills

5338 SW Irish

Topeka Kansas Zip 66610

FEE: \$

COUNTY RECORDER

NOTICE OF MINING CLAIM LOCATION

- X Location Amendment Placer X Lode Millsite Tunnelsite
- Name of Claim: SMH #3
- Name of Locator: Tomas Mills
- Located in Section        Township 12 N Range 9 West  
District, Eureka County, Yavapai
- Type of Location Monument is 4 X 4 Wood Post ✓ Type of corner monument is 4 X 4 Wood Post.
- The bearing and distance between corner of the claim are: Beginning at the SE corner of the claim, 600 feet in a W direction to the SW corner, then 1500 feet in a N direction to the NW corner, then 600 feet in a E direction to the corner, then 1600 feet in a S direction to the point of beginning.
- The location of the claim occupies all or part of the following quarter-sections:  
Quarter-Sections SE 1/4 Section(s) 21 Township(s) 12 N Range(s) 9 W
- If Amending relocating or previously recorded, the claim was recorded in 1864 Docket, 905 Page, Eureka Mining District.  
BLM FMC # 261041

RECEIVED  
BLM STATE OFFICE  
ARIZONA  
NOV 21 4 10 PM '95

A MC 336029

SIGNATURES:

Donald H Blackburn

Agent for  
Tom Mills

N  
↑

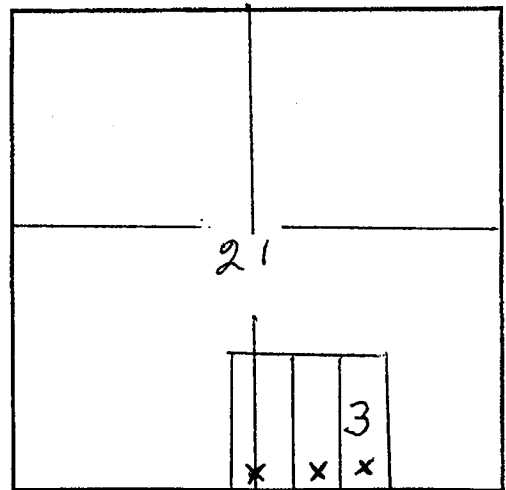

- x = Location Monument
- 0 = Survey Market
- = Wood Posts

Date: Nov 20 - 95



WHEN RECORDED |||| TO:

Tom Mills

5338 SW Urish

Topeka Kansas Zip 66610

FEE: \$

COUNTY RECORDER

**NOTICE OF MINING CLAIM LOCATION**

1. X Location    Amendment    Placer    X Lode    Millsite    Tunnelsite

2. Name of Claim: SMH # 4

3. Name of Locator: Tom Mills

4. Located in Section 28 Township 12 N Range 9 W

District, Eureka County, Yavapai

5. Type of Location Monument is 4 X 4 Wood Post A Type of corner monument is 4 X Wood Post

6. The bearing and distance between corner of the claim are: Beginning at the NE corner of the claim, 600 feet in a W direction to the NW corner, then 1500 feet in a S direction to the SW corner, then 600 feet in a E direction to the corner, then 1500 feet in a N direction to the point of beginning.

7. The location of the claim occupies all or part of the following quarter-sections:

Quarter-Sections NW 1/4 Section(s) 28 Township(s) 12 N Range(s) 9 W

8. If Amending, relocating, or previously recorded, the claim was recorded in

1864 Docket, 907 Page, Eureka Mining District.

BLM FMC # 261042

**SIGNATURES:**

Donald F. Blackburn

Agent for  
Tom Mills

N  
↑

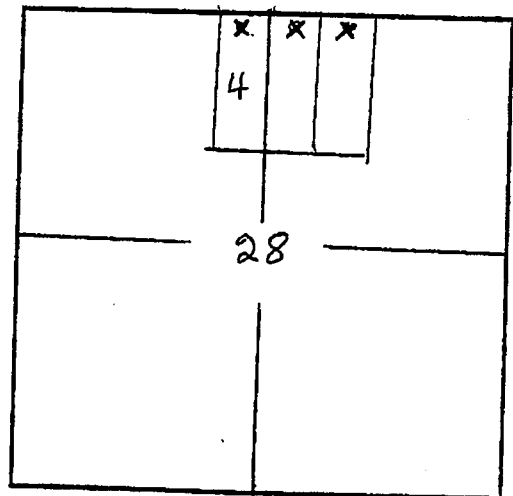

RECEIVED

A MC 336030

ARIZONA STATE MINING BUREAU OFFICE  
NOV 21 10 49 AM '95

- x = Location Monument
- o = Survey Market
- = Wood Posts

Date: Nov 20 - 95

WHEN RECORDED 1111 TO:

TOM MILLS

5338 SW Urish

Topeka Kansas Zip 66610

FEE: \$

COUNTY RECORDER

**NOTICE OF MINING CLAIM LOCATION**

1. X Location Amendment Placer X Lode Millsite Tunnelsite
2. Name of Claim: SMH # 5
3. Name of Locator: Tomas Mills
4. Located in Section 28 Township 12 N Range 9 W Mining District, Eureka County, Yavapai
5. Type of Location Monument is 4 X 4 Wood Post Δ Type of corner monument is 4 X 4 Wood Post.
6. The bearing and distance between corner of the claim are: Beginning at the NE corner of the claim, 600 feet in a W direction to the NW corner, then 1500 feet in a S direction to the SW corner, then 600 feet in a E direction to the corner, then 1500 feet in a N direction to the point of beginning.
7. The location of the claim occupies all or part of the following quarter-sections:  
Quarter-Sections NE 1/4 Section(s) 28 Township(s) 12 N Range(s) 9 W
8. If Amending, relocating or previously recorded, the claim was recorded in 1864 Docket, 909 Page, Eureka Mining District.  
BLM AMC # 261043

A MC 336031

SIGNATURES:

Donald A Blackburn

Agent for  
Tom Mills

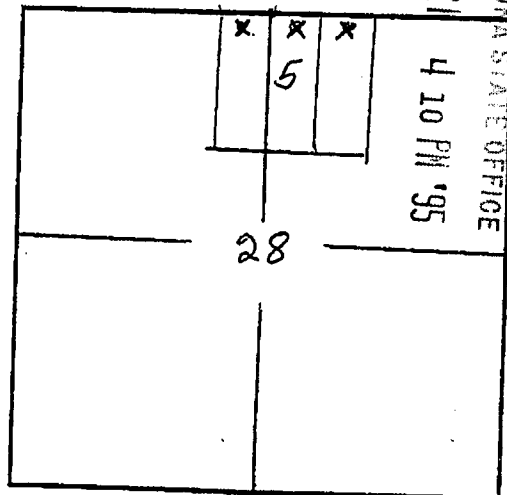

- x = Location Monument
- 0 = Survey Market
- = Wood Posts

Date: Nov 20 - 95

WHEN RECORDED MAILBOX:

TOM MILLS  
5338 SW Urish  
Topeka Kansas Zip 66610

FEE: \$

COUNTY RECORDER

**NOTICE OF MINING CLAIM LOCATION**

1. X Location Amendment Placer X Lode Millsite Tunnelsite
2. Name of Claim: SMH # 6
3. Name of Locator: Tomas Mills
4. Located in Section 28 Township 12 N Range 9 W Mining District, Eureka County, Yavapai
5. Type of Location Monument is 4 X 4 Wood Post A Type of corner monument is 4 X 4 Wood Post.
6. The bearing and distance between corner of the claim are: Beginning at the NE corner of the claim, 600 feet in a W direction to the NW corner, then 1500 feet in a S direction to the SW corner, then 600 feet in a E direction to the corner, then 1500 feet in a N direction to the point of beginning.
7. The location of the claim occupies all or part of the following quarter-sections:  
Quarter-Sections NE 1/4 Section(s) 28 Township(s) 12 N Range(s) 9 W
8. If Amending, (relocating) or previously recorded, the claim was recorded in 1864 Docket, 911 Page, Eureka Mining District.  
BLM AMC # 261044

SIGNATURES:

Donald H Blackburn

Agent for  
Tom Mills

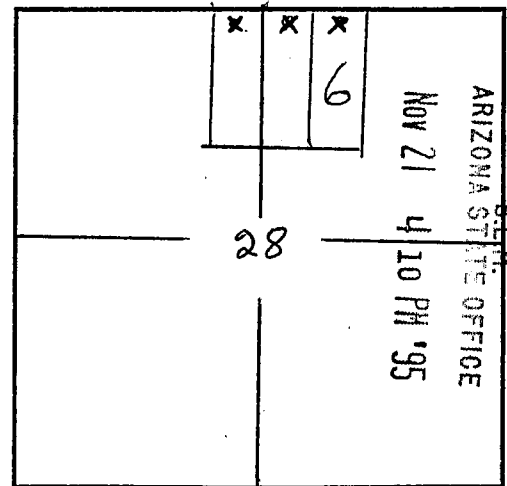

RECEIVED

- x = Location Monument
- 0 = Survey Market
- = Wood Posts

Date: Nov 20 - 95

A HC 336032

WHEN RECORDED MAIL TO:

Tom Mills  
5338 SW Irish  
Topeka Kansas 66610

FEE: \$

COUNTY RECORDER

NOTICE OF MINING CLAIM LOCATION

- Location  Amendment  Placer  Lode  Millsite  Tunnelsite
- Name of Claim: S M H # 7
- Name of Locator: Tomas Mills
- Located in Section 28 Township 12 N Range 9 W Mining District, Eureka County, Yavapai
- Type of Location Monument is 4 X 4 Wood Post 2 Type of corner monument is 4 X 4 Wood Post.
- The bearing and distance between corner of the claim are: Beginning at the SW corner of the claim, 600 feet in a N direction to the NW corner, then 1320 feet in a E direction to the NE corner, then 600 feet in a S direction to the corner, then 1320 feet in a W direction to the point of beginning.
- The location of the claim occupies all or part of the following quarter-sections:  
Quarter-Sections SE 1/4 Section(s) 28 Township(s) 12 N Range(s) 9 W
- If Amending, (relocating) or previously recorded, the claim was recorded in 1864 Docket, 913 Page, Eureka Mining District.  
BLM AMC # 261045

A MC 336033

SIGNATURES:

Donald H. Blackburn  
Agent for Tomas  
Mills

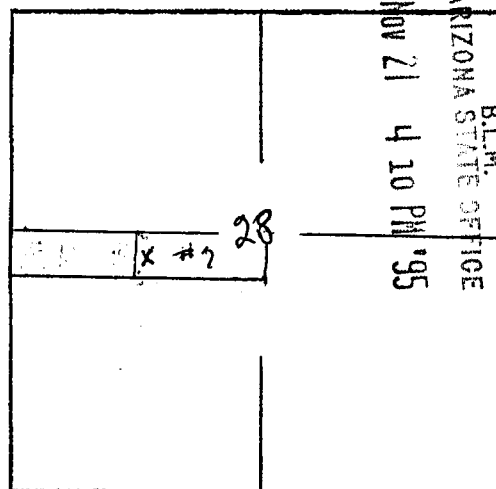

N  
↑

- x = Location Monument
- o = Survey Market
- = Wood Posts

Date: Nov 20 - 95

WHEN RECORDED MAIL :

Tom Mills  
5338 SW Irish  
Topeka Kansas 66610

FEE: \$

COUNTY RECORDER

NOTICE OF MINING CLAIM LOCATION

- Location  Amendment  Placer  Lode  Millsite  Tunnelsite
- Name of Claim: S M H # 8
- Name of Locator: Tomas Mills
- Located in Section 28 Township 12 N Range 9 W Mining District, Eureka County, Yavapai
- Type of Location Monument is 4 X 4 Wood Post  Type of corner monument is 4 X 4 Wood Post.
- The bearing and distance between corner of the claim are: Beginning at the N/E corner of the claim, 600 feet in a S direction to the S/E corner, then 1320 feet in a W direction to the SW corner, then 600 feet in a N direction to the corner, then 1320 feet in a NW direction to the point of beginning.
- The location of the claim occupies all or part of the following quarter-sections:  
Quarter-Sections SE 1/4 Section(s) 28 Township(s) 12 N Range(s) 9 W
- If Amending, relocating or previously recorded, the claim was recorded in 1864 Docket, 915 Page, Eureka Mining District.  
BLM FMC # 261046

A MC 336034

SIGNATURES:

Donald H Blackburn  
Agent for Tomas  
Mills

N  
↑

#8 x	28	RECEIVED B.L.M. ARIZONA STATE OFFICE NOV 21 4 10 PM '95

- x = Location Monument
- o = Survey Market
- = Wood Posts

Date: Nov 20 - 95

# TOWNSHIP 12 NORTH RANGE 9 WEST OF THE GILA AND SALT RIVER MERIDIAN, ARIZONA

STATUS OF PUBLIC DOMAIN  
LAND AND MINERAL TITLES

YAVAPAI COUNTY

INDEX TO SEGREGATED TRACTS				
RESURVEY TRACT NO	ORIGINAL SURVEY			
	T	R	SEC	SUBDIVISION

FOR ORDERS EFFECTING DISPOSAL OR USE OF UNIDENTIFIED LANDS WITHDRAWN FOR CLASSIFICATION, MINERALS, WATER AND/OR OTHER PUBLIC PURPOSES, REFER TO INDEX OF MISCELLANEOUS DOCUMENTS.

DIST. NO. 2

MDS 330 NE  
331 SW

Nov 22 7 30 AM '95

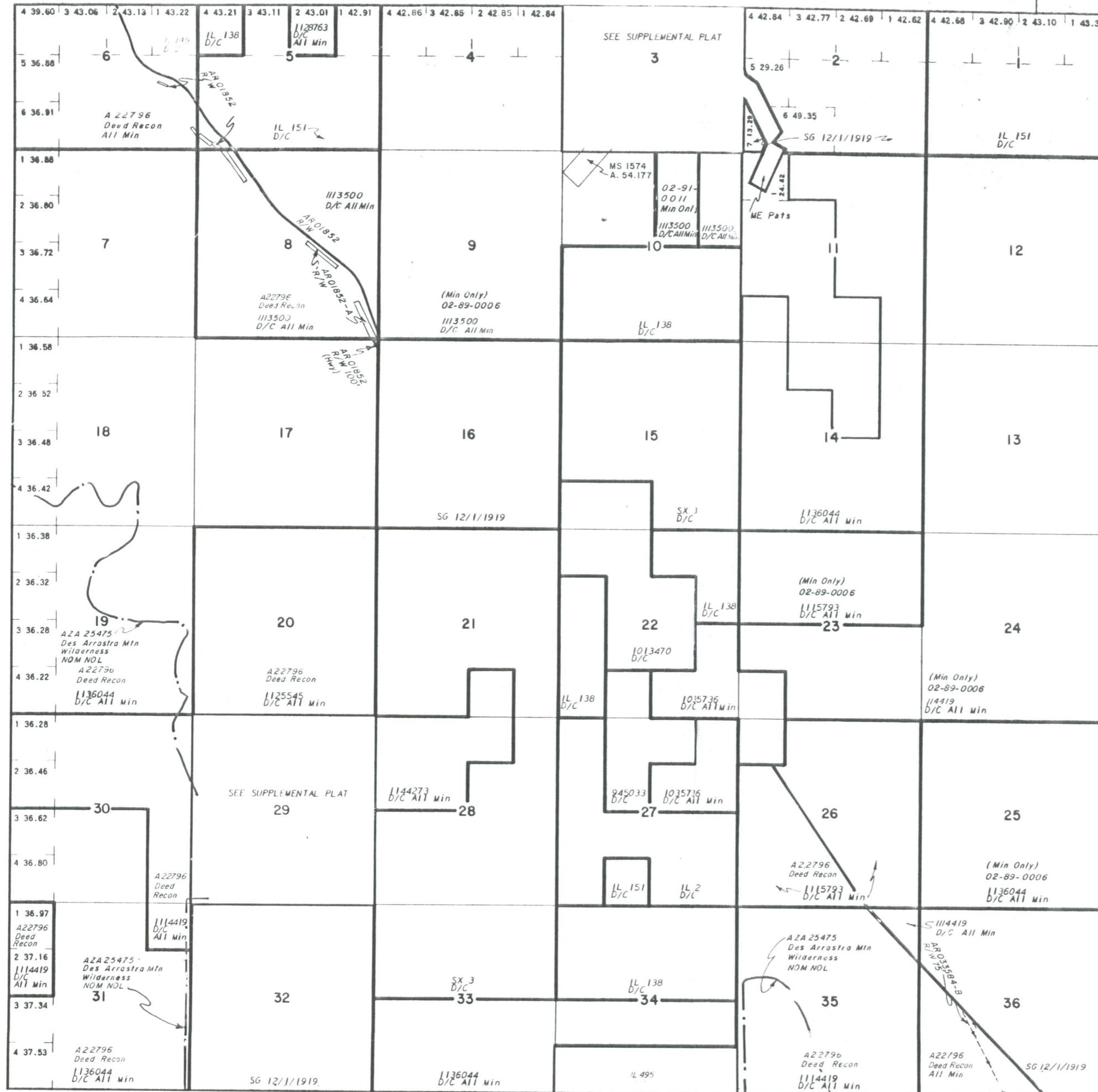

Lat. 34°19'45" N  
Long. 113°08'37" W

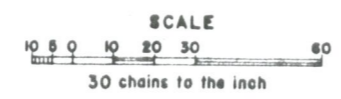

**WARNING STATEMENT**  
This plat is the Bureau's Record of Title and should be used only as a graphic display of the township survey data. Records hereon do not reflect title changes which may have been effected by lateral movements of rivers or other bodies of water. Refer to the cadastral surveys for official survey information.

CURRENT TO	BY

T. 12 N  
R. 9 W

-----  
 GEOGRAPHIC STATE: ARIZONA                      MERIDIAN: 14    TOWNSHIP: 12-DN    RANGE: 9-DW  
 -----

SEC	SUBDIVISION	MIR	X-REFERENCE	NUMBER/TYPE/DISPOSITION/ACRES	PROPRIETOR/INTEREST/RELATIONSHIP
36	W2	14	4-DN 1-DE	CASE: AZA 012037	DOE WTN AREA PWR ADM 100.00000% HOLDER
		14	4-DN 4-OW	TYPE: 285007 ROW-PWR LINE FED FA	
		14	5-DN 6-OW	DISP: AUTHORIZED 01/07/94	
		14	6-DN 6-OW	ACRS: 02231.010	
		14	11-DN 8-OW		
		14	11-DN 9-OW		
		14	13-DN 10-OW		
		14	13-DN 11-OW		
		14	14-DN 11-OW		
		14	14-DN 12-OW		
		14	15-DN 12-OW		
		14	16-DN 12-OW		
		14	16-DN 13-OW		
		14	16-2N 13-OW		
		14	17-DN 13-OW		
		14	18-DN 13-OW		
		14	23-DN 13-OW		
		14	23-DN 14-OW		
		14	24-DN 14-OW		
		14	25-DN 14-OW		
		14	25-DN 15-OW		
		14	26-DN 15-OW		
		14	26-DN 16-OW		
		14	27-DN 16-OW		
		14	27-DN 17-OW		
		14	27-DN 18-OW		
		14	28-DN 18-OW		
		14	28-DN 19-OW		
		14	28-DN 20-OW		
		14	28-DN 21-OW		
8	ALL			CASE: AZA 014555	PIONEER PROD CORP 100.00000% LESSEE
35	ALL			TYPE: 311111 O&G LSE NONCOMP PUB	
				DISP: CLOSED 05/01/85	
				ACRS: 01280.000	
9	ALL			CASE: AZA 014752	IREX OVERTHRUST AC 100.00000% LESSEE
14	S2			TYPE: 311111 O&G LSE NONCOMP PUB	
22	S2SE, NESE			DISP: CLOSED 11/01/85	
23	ALL			ACRS: 02480.000	
26	ALL				
27	E2NE, SWNE				
7	E2, E2W2			CASE: AZA 015388	RETAMCO INC 100.00000% LESSEE
7	LOT 1-4			TYPE: 311111 O&G LSE NONCOMP PUB	
12	ALL			DISP: CLOSED 03/01/85	
13	ALL			ACRS: 05387.400	
17	ALL				
19	E2, E2W2				

-----  
GEOGRAPHIC STATE: ARIZONA                    MERIDIAN: 14    TOWNSHIP: 12-0N    RANGE: 9-0W  
-----

SEC	SUBDIVISION	MTR	X-REFERENCE	NUMBER/TYPE/DISPOSITION/ACRES	PROPRIETOR/INTEREST/RELATIONSHIP
36	SW	14	11-0N 8-0W	CASE: AZAR 0035584B	DOE WTN AREA PWR ADM 100.00000% HOLDER
		14	11-0N 9-0W	TYPE: 285011 ROW-PWR LINE RECONV	
		14	13-0N 10-0W	DISP: AUTHORIZED 11/16/87	
				ACRS: 00097.730	



GEOGRAPHIC STATE: ARIZONA MERIDIAN: 14 TOWNSHIP: 12-0N RANGE: 9-0W

SEC	SUBDIVISION	MIR X-REFERENCE	NUMBER/TYPE/DISPOSITION/ACRES	PROPRIETOR/INTEREST/RELATIONSHIP
20	PART		CASE: AZA 026846	WESTBROOK BOBBY 0.00000% OPERATOR
21	PART		TYPE: 380913 SURFACE MGT-NOTICE	WESTBROOK BOBBY 100.00000% CLAIMANT
28	PART	~4	DISP: CLOSED 08/13/87	
29	PART		ACRS: 00001.000	
30	PART			
32	PART			
20	PART		CASE: AZA 026855	TRC RESOURCES INC 0.00000% OPERATOR
21	PART		TYPE: 380913 SURFACE MGT-NOTICE	TRC RESOURCES INC 100.00000% CLAIMANT
28	PART		DISP: CLOSED 09/29/87	
29	PART		ACRS: 00001.000	
30	PART			
11	PART		CASE: AZA 027097	QUEST INC 100.00000% CLAIMANT
14	PART		TYPE: 380913 SURFACE MGT-NOTICE	STANNUS B R 0.00000% OPERATOR
			DISP: CLOSED 08/21/89	
			ACRS: 00001.000	
11	S2NW, N2SW, SE9W, SW9E	14 12-0N 5-0W	CASE: AZA 027462FD	BLM PHOENIX DO 100.00000% ADMIN MGT ENT
11	LOT 1	14 13-0N 4-0W	TYPE: 220100 EX-BLM SEC 206, FLP	
14	W2NE, NENW	14 14-0N 4-0W	DISP: CLOSED 05/24/95	
		14 22-0N 17-0W	ACRS: 11663.290	
		14 24-0N 16-0W		
		14 24-0N 17-0W		
		14 25-0N 16-0W		
11	ALL		CASE: AZA 027466	DEL TIERRA ENG 100.00000% CLAIMANT
14	ALL		TYPE: 380913 SURFACE MGT-NOTICE	
			DISP: CLOSED 06/21/90	
			ACRS: 00001.000	
29	NE		CASE: AZA 027889	BLACKBURN DON 0.00000% CLAIMANT
			TYPE: 380913 SURFACE MGT-NOTICE	HUNTER DERK 0.00000% CLAIMANT
			DISP: AUTHORIZED 06/09/93	PM MINING 100.00000% OPERATOR
			ACRS: 00001.000	
5	SWSW		CASE: AZAR 0001852	AZ SHWY 100.00000% HOLDER
6	E2SE		TYPE: 282105 FED AID HIGHWAY (SE	
8	N2NW		DISP: AUTHORIZED 03/17/92	
17	NENENE		ACRS: 00005.200	
8	SWNE, N2SE, SESE		CASE: AZAR 0001852A	AZ SHWY 100.00000% HOLDER
17	NENENE		TYPE: 289011 ROW-OTHER RECONVEYE	
			DISP: AUTHORIZED 12/31/68	
			ACRS: 00007.480	

-----  
 GEOGRAPHIC STATE: ARIZONA                      MERIDIAN: 14    TOWNSHIP: 12-0N    RANGE: 9-0W  
 -----

SEC	SUBDIVISION	MIR	X-REFERENCE	NUMBER/TYPE/DISPOSITION/ACRES	PROPRIETOR/INTEREST/RELATIONSHIP
19	LOT 1-4				
20	ALL				
30	E2,E2W2				
30	LOT 1-4				
31	E2W2,E2				
31	LOT 1-4				
33	S2				
24	ALL			CASE: AZA    015566	PATRICK PETRO CORP    100.00000% LESSEE
25	ALL			TYPE: 311111 O&G LSE NONCOMP PUB	
				DISP: CLOSED    03/01/85	
				ACRS: 01280.000	
24	ALL			CASE: AZA    019188	BEARD JOHN M            0.00000% 1ST PRIORITY
25	ALL			TYPE: 311211 O&G LSE SIMO PUBLIC	
				DISP: CLOSED    09/14/84	
				ACRS: 01280.000	
*11	S2NW, N2SW, SESE, SWSE	14	1-0N    3-0W	CASE: AZA    020346PF	BLM PHOENIX DO        100.00000% ADMIN MGT ENT
*11	LOT 1	14	1-0N    4-0W	TYPE: 221006 EX-STATE SEC 206, F	
*14	W2NE, NENW	14	1-0N    10-0W	DISP: CLOSED    04/10/91	
		14	1-0S    5-0W	ACRS: 39974.460	
		14	1-0S    6-0W		
		14	1-0S    7-0W		
		14	1-0S    9-0W		
		14	2-0N    5-0W		
		14	2-0N    6-0W		
		14	2-0N    9-0W		
		14	2-0N    10-0W		
		14	3-0N    9-0W		
		14	3-0N    10-0W		
		14	3-0N    11-0W		
		14	3-0N    12-0W		
		14	4-0N    15-0W		
		14	5-0N    12-0W		
		14	5-0N    13-0W		
		14	5-0S    10-0W		
		14	6-0N    11-0W		
		14	6-0N    12-0W		
		14	6-0N    13-0W		
		14	6-0S    4-0W		
		14	6-0S    7-0W		
		14	6-0S    10-0W		
		14	6-0S    11-0W		
		14	6-0S    12-0W		
		14	6-0S    13-0W		
		14	6-0S    14-0W		
		14	7-0N    5-0W		
		14	7-0N    6-0W		
		14	7-0N    7-0W		

\* = REJECTED/SEGREGATED/ASSIGNED-OUT

-----  
 GEOGRAPHIC STATE: ARIZONA                      MERIDIAN: 14    TOWNSHIP: 12-0N    RANGE: 9-0W  
 -----

SEC	SUBDIVISION	MIR	X-REFERENCE	NUMBER/TYPE/DISPOSITION/ACRES	PROPRIETOR/INTEREST/RELATIONSHIP
		14	7-0S	11-0W	
		14	7-0S	12-0W	
		14	7-0S	14-0W	
		14	8-0N	7-0W	
		14	8-0N	9-0W	
		14	8-0S	14-0W	
		14	12-0N	5-0W	
		14	13-0N	4-0W	
		14	14-0N	4-0W	
5	SW SWLY OF HWY 93	14	11-0N	8-0W	CASE: AZA 022796PT                      BLM ARIZONA SO                      100.00000% ADMIN MGT ENT
6	SWLY OF HWY 93	14	11-0N	9-0W	TYPE: 221006 EX-STATE SEC 206, F
7	E2,E2W2	14	11-0N	10-0W	DISP: AUTHORIZED 03/09/88
7	LOT 1-4	14	12-0N	10-0W	ACRS: 32359.590
8	SWLY OF HWY 93	14	13-0N	9-0W	
17	ALL	14	13-0N	10-0W	
18	E2,E2W2	14	14-0N	9-0W	
18	LOT 1-4	14	14-0N	10-0W	
19	E2,E2W2				
19	LOT 1-4				
20	ALL				
26	SWLY OF HWY 93, EX PATENT				
29	NENE, W2W2, SESW, NESE, S2SE				
29	LOT 1-6				
30	E2,E2W2				
30	LOT 1-4				
31	E2,E2W2				
31	LOT 1-4				
35	SWLY OF HWY 93				
36	SWLY OF HWY 93				
4	S2	14	10-0N	6-0W	CASE: AZA 023217AF                      SANTA FE PACIFIC RR                      100.00000% PATENTEE
4	LOT 1-4	14	10-0N	7-0W	TYPE: 220100 EX-BLM SEC 206, FLP
9	ALL	14	10-0N	8-0W	DISP: AUTHORIZED 10/26/88
10	NW	14	11-0N	5-0W	ACRS: 99999.999
12	ALL	14	11-0N	6-0W	
13	ALL	14	11-0N	7-0W	
23	N2, E2SW, NWSW, SE	14	11-0N	8-0W	
24	ALL	14	12-0N	6-0W	
25	ALL	14	12-0N	7-0W	
		14	12-0N	8-0W	
		14	13-0N	4-0W	
		14	13-0N	5-0W	
		14	13-0N	6-0W	
		14	13-0N	7-0W	
		14	13-0N	8-0W	
		14	13-0N	9-0W	
		14	14-0N	4-0W	
		14	14-0N	5-0W	
		14	14-0N	6-0W	

GEOGRAPHIC STATE: ARIZONA MERIDIAN: 14 TOWNSHIP: 12-0N RANGE: 9-0W

SEC	SUBDIVISION	MTR	X-REFERENCE	NUMBER/TYPER/DISPOSITION/ACRES	PROPRIETOR/INTEREST/RELATIONSHIP
		14	14-0N 9-0W		
		14	14-2N 6-0W		
		14	14-2N 8-0W		
		14	15-0N 6-0W		
		14	15-0N 7-0W		
		14	15-0N 8-0W		
		14	15-0N 9-0W		
		14	16-0N 9-0W		
10	NE	14	10-0N 6-0W	CASE: AZA 023217FD	BLM KINGMAN RA 100.00000Z ADMIN MGT ENT
11	NE, NENW, SWSW, N2SE, SESE	14	10-0N 7-0W	TYPE: 220100 EX-BLM SEC 206, FLP	
14	E2NE, W2NW, SENW, S2	14	10-0N 8-0W	DISP: CLOSED 03/19/91	
*04	S2	14	11-0N 5-0W	ACRS: 23427.470	
*04	LOT 1-4	14	11-0N 6-0W		
*09	ALL	14	11-0N 7-0W		
*10	NW	14	11-0N 8-0W		
*12	ALL	14	12-0N 5-0W		
*13	ALL	14	12-0N 6-0W		
*23	N2, E2SW, NWSW, SE	14	12-0N 7-0W		
*24	ALL	14	12-0N 8-0W		
*25	ALL	14	13-0N 4-0W		
		14	13-0N 5-0W		
		14	13-0N 6-0W		
		14	13-0N 7-0W		
		14	13-0N 8-0W		
		14	13-0N 9-0W		
		14	14-0N 4-0W		
		14	14-0N 5-0W		
		14	14-0N 6-0W		
		14	14-0N 9-0W		
		14	14-2N 6-0W		
		14	14-2N 8-0W		
		14	15-0N 6-0W		
		14	15-0N 7-0W		
		14	15-0N 8-0W		
		14	15-0N 9-0W		
		14	16-0N 9-0W		
		14	16-2N 9-0W		
11	S2NW, N2SW, SESW, SWSE	14	1-0N 6-0W	CASE: AZA 023631FD	BLM PHOENIX DO 100.00000Z ADMIN MGT ENT
11	LOT 1	14	1-0N 10-0W	TYPE: 221006 EX-STATE SEC 206, F	
14	W2NE, NENW	14	1-0S 1-0W	DISP: CLOSED 04/10/91	
		14	1-0S 6-0W	ACRS: 12819.640	
		14	1-0S 7-0W		
		14	1-0S 9-0W		
		14	2-0N 9-0W		
		14	2-0N 10-0W		
		14	3-0N 9-0W		
		14	3-0N 10-0W		
		14	3-0N 11-0W		

\* = REJECTED/SEGREGATED/ASSIGNED-OUT

-----  
 GEOGRAPHIC STATE: ARIZONA                      MERIDIAN: 14    TOWNSHIP: 12-0N    RANGE: 9-0W  
 -----

SEC	SUBDIVISION	MIR	X-REFERENCE	NUMBER/TYPE/DISPOSITION/ACRES	PROPRIETOR/INTEREST/RELATIONSHIP
		14	3-0N 12-0W		
		14	5-0N 12-0W		
		14	5-0N 13-0W		
		14	5-0S 10-0W		
		14	6-0N 13-0W		
		14	6-0S 4-0W		
		14	6-0S 7-0W		
		14	6-0S 10-0W		
		14	6-0S 11-0W		
		14	6-0S 12-0W		
		14	6-0S 13-0W		
		14	6-0S 14-0W		
		14	7-0N 6-0W		
		14	7-0N 7-0W		
		14	7-0S 11-0W		
		14	7-0S 12-0W		
		14	7-0S 14-0W		
		14	8-0N 7-0W		
		14	8-0N 9-0W		
		14	8-0S 14-0W		
		14	12-0N 5-0W		
		14	13-0N 4-0W		
		14	14-0N 4-0W		
10	W2NE	14	10-0N 6-0W	CASE: AZA 025033AF	SANTA FE PACIFIC RR 100.00000% PATENTEE
		14	10-0N 7-0W	TYPE: 220100 EX-BLM SEC 206, FLP	
		14	11-0N 8-0W	DISP: AUTHORIZED 04/03/91	
		14	12-0N 6-0W	ACRS: 03995.090	
		14	13-0N 8-0W		
		14	14-0N 4-0W		
		14	14-0N 9-0W		
11	S2NW, N2SW, SE9W, SW9E	14	1-0N 6-0W	CASE: AZA 025088FD	BLM PHOENIX DO 100.00000% ADMIN MGT ENT
11	LOT 1	14	1-0N 10-0W	TYPE: 220100 EX-BLM SEC 206, FLP	
14	W2NE, NENW	14	1-0S 6-0W	DISP: CLOSED 05/24/95	
		14	1-0S 7-0W	ACRS: 21718.470	
		14	1-0S 9-0W		
		14	2-0N 9-0W		
		14	2-0N 10-0W		
		14	3-0N 9-0W		
		14	3-0N 10-0W		
		14	3-0N 11-0W		
		14	3-0N 12-0W		
		14	5-0N 12-0W		
		14	5-0N 13-0W		
		14	5-0S 10-0W		
		14	6-0N 13-0W		
		14	6-0S 4-0W		
		14	6-0S 7-0W		
		14	6-0S 10-0W		

GEOGRAPHIC STATE: ARIZONA                      MERIDIAN: 14    TOWNSHIP: 12-DN    RANGE: 9-DW

SEC	SUBDIVISION	MIR	X-REFERENCE	NUMBER/TYPE/DISPOSITION/ACRES	PROPRIETOR/INTEREST/RELATIONSHIP
		14	6-OS 11-DW		
		14	6-OS 12-DW		
		14	6-OS 13-DW		
		14	6-OS 14-DW		
		14	7-DN 6-DW		
		14	7-DN 7-DW		
		14	7-OS 11-DW		
		14	7-OS 12-DW		
		14	7-OS 14-DW		
		14	8-DN 7-DW		
		14	8-DN 9-DW		
		14	8-OS 14-DW		
		14	12-DN 5-DW		
		14	13-DN 4-DW		
		14	14-DN 4-DW		
18	PT OF S2S2	14	11-DN 9-DW	CASE: AZA 025475	BLM PHOENIX DO 100.00000% ADMIN MGT ENT
19	ALL	14	11-DN 10-DW	TYPE: 231106 WDL-BLM WILDERNESS	
29	PT OF W2SW	14	11-DN 11-DW	DISP: AUTHORIZED 11/28/90	
30	ALL	14	11-DN 12-DW	ACRS: 99999.999	
31	ALL	14	12-DN 10-DW		
35	PT OF SW & S2NW	14	12-DN 11-DW		
		14	12-DN 12-DW		
		14	12-DN 13-DW		
		14	13-DN 11-DW		
		14	13-DN 12-DW		
		14	13-DN 13-DW		
1	ALL	14	10-DN 8-DW	CASE: AZA 025965	COLORADO OUTWARD BOU 100.00000% PERMITTEE
		14	10-DN 9-DW	TYPE: 837000 RECREATION USE AUTH	
		14	10-DN 10-DW	DISP: CLOSED 11/10/92	
		14	10-DN 11-DW	ACRS: 00000.940	
		14	11-DN 8-DW		
		14	11-DN 9-DW		
		14	11-DN 10-DW		
		14	11-DN 11-DW		
		14	12-DN 8-DW		
		14	12-DN 10-DW		
		14	12-DN 11-DW		
20	PART			CASE: AZA 026823	TRC RESOURCES INC 0.00000% OPERATOR
21	PART			TYPE: 380913 SURFACE MGT-NOTICE	TRC RESOURCES INC 100.00000% CLAIMANT
28	PART - NA			DISP: CLOSED 08/13/87	
29	PART			ACRS: 00001.000	
30	PART				
32	PART				